

**FAIRFAX COUNTY WATER AUTHORITY, CENTRAL MAINTENANCE FACILITY  
2926, 2930, 2934 INDUSTRY LANE, FAIRFAX, VA 22031**

**TECHNICAL SPECIFICATIONS AND PERFORMANCE CRITERIA**

This specification establishes the minimum requirements for the acquisition and installation of the following appliances: task and training seating, training and breakroom tables, adjustable height desks, filing and storage, fixed height desks, and miscellaneous accessory items. Provide in accordance with the furniture plan, Basis of Design as shown and specified herein.

**TECHNICAL SPECIFICATIONS AND PERFORMANCE CRITERIA**

**SEATING**

**Item C01 Training Room Chair, Stacking, Glides, Upholstered, Mesh Back**

1. Multi-purpose Training Chair: Stackable, fixed arms, and cantilever base
2. Overall dimensions: 23.23” W x 21.19” D x 36.68” H
3. Frame construction: 100% recyclable aluminum tubular frame, welded
4. Seat construction: Contoured seat cushion with mesh seat with frameless front edge
5. Back construction: Tri-panel non-stretch mesh, with automatic lumbar support, and 8 degree tilt
6. Arms: Fixed tubular frame with urethane arm caps
7. Upholstery shall be bleach cleanable non-woven polyurethane material, water repellent, 300,000 double rubs (Wyzenbeek), 160,000 rubs (Martindale).
8. Maximum User Weight: 300lbs
9. Finish: Chrome 3 plated metal finish on frame, non-woven upholstered seat, mesh back
10. Warranty: 15-years, Fabric/Cushions: 5 years, single shift
11. BOD: Human Scale Liberty Occasional or Equal.



*Image shown is similar to Basis of Design product specified and is for reference only. Product requirements are listed above.*

**TECHNICAL SPECIFICATIONS AND PERFORMANCE CRITERIA**

**SEATING**

**Item C02 Office Task Chair**

1. Task Chair: Adjustable arms, adjustable height, casters
2. Overall dimensions: 30" W x 38.75" H
3. 5-star die-cast aluminum base and 2.5" casters suitable for use on hard floors
4. Seat construction: Height and depth adjustable, mesh suspended seat
5. Seat depth: 16 ¼"-18" adjustable
6. Seat height: 16"-20 ½" standard-height adjustable range
7. Back construction: Butterfly shape, sacral support, torsional flex technology, height adjustable lumbar support, with flexible, breathable poly mesh back. Ergonomic recline with adjustable back tilt
8. Maximum User Weight: 350lbs
9. Finish: Chrome base, poly mesh back, mesh suspended seat
10. Warranty: 12-year Parts & Labor Manufacturer's Warranty
11. BOD: Herman Miller Mirra Chair or Equal.



*Image shown is similar to Basis of Design product specified and is for reference only. Product requirements are listed above.*

**TECHNICAL SPECIFICATIONS AND PERFORMANCE CRITERIA**

**SEATING**

**Item C03 Map/Plan Room Stool**

1. Low Back Task Stool: Adjustable height, fixed non-adjustable arms, casters
2. Overall dimensions: 50.5” H 26.75” W 26.75” D
3. Five-star base with painted metal finish, 20” DIA adjustable height footrest ring with chrome finish, 2.5” hard floor caster with quiet roll technology
4. Seat construction: Breathable mesh suspended and continuous from seat to back, auto-tilt support and balanced recline
5. Seat depth: 15.4” fixed depth
6. Seat height: 22 4/5”-32 1/2” adjustable height range
7. Back construction: Breathable mesh suspended and continuous from seat to back
8. Maximum User Weight: 350lbs
9. Finish: dipped-in-color, one hue from top to bottom, suspended mesh seat and back
10. Warranty: 12-year Parts & Labor Manufacturer’s Warranty
11. BOD: Herman Miller Cosm Stool or Equal.



*Image shown is similar to Basis of Design product specified and is for reference only. Product requirements are listed above.*

**TECHNICAL SPECIFICATIONS AND PERFORMANCE CRITERIA**

**DESKS**

**Item D01 Fleet Tech Office Desk,**

1. Fixed height L-shape desk, metal support legs, (1) box/box/file storage, no overhead storage
2. Overall Dimensions: 78" W x 78" D x 27-3/4"H, worksurface to be 24" D with concave curved corner
3. Worksurface: 1-1/4" thick high-pressure plastic laminate with matching PVC edge band, BIFMA Compliant
4. Box/box/file: 15"W x 18"D x 25-7/8"H, free-standing on glides
5. Construction: painted steel metal frame, metal closed support leg, extended corner surface, modesty panel both sides of desk, writing surface with 90-degree concave corner surface
6. Provide three grommets per desk; minimum 24" long power strip, horizontal and vertical cable management
7. Base Finish: Powder-coated painted metal
8. Exceeds rigid quality and testing standards of BIFMA and GSA
9. Warranty: 12-years Parts & Labor Manufacturer's Warranty
10. BOD: Herman Miller Canvas Metal Desking or Equal.



*Image shown is similar to Basis of Design product specified and is for reference only. Product requirements are listed above.*

**TECHNICAL SPECIFICATIONS AND PERFORMANCE CRITERIA**

**DESKS**

**Item D02 Desk, Warehouse Office Desk**

1. Fixed height desk: Metal support legs, (1) box/box/file storage, no overhead storage
2. Overall Dimensions: 72” W x 30” D x 28-3/4”H
3. Worksurface: 1-1/4” thick high-pressure plastic laminate with matching PVC edge band, BIFMA Compliant
4. Box/box/file: 15” W x 27-7/8” D x 25-7/8” H, free-standing on glides
5. Construction: Painted steel metal frame, metal closed support leg, full-length modesty panel
6. Provide two grommets per desk, minimum 24” long power strip, horizontal and vertical cable management
7. Base Finish: Powder-coated painted metal
8. Exceeds rigid quality and testing standards of BIFMA and GSA
9. Warranty: 12-year Parts & Labor Manufacturers Warranty
10. BOD: Herman Miller Canvas Metal Desking or Equal.



*Image shown is similar to Basis of Design product specified and is for reference only. Product requirements are listed above.*

**TECHNICAL SPECIFICATIONS AND PERFORMANCE CRITERIA**

**DESKS**

**Item D03 Desk, Private Office Desk,**

1. Height-adjustable desk with overhead storage: (1) Box/file low storage, (1) low credenza open shelf, (1) low credenza two-door storage, (1) bookshelf and box/file storage combination, (1) horizontal wire management trough, (1) vertical cable manager, (1) tackable surface, (1) under-overhead cabinet lighting
2. Overall Dimensions: 9'-6" W x 6'-0" D x 5'-7"H
3. Box/File low storage: 36" W x 21" H x 20" D
4. Low credenza open shelf: 30" W x 21" H x 16" D; adjustable-height leg goes behind open shelf; provide access to wall outlet behind and grommets in shelf and top surface to allow for wire management through the unit; top surface is 20"D with finished opening for adjustable height leg.
5. Low credenza two-door storage: 30" W x 21" H x 20" D
6. Bookshelf and box/file storage combination: 24" W x 20" D; box/file is 21"H; bookshelf attaches on top for a total height of 67" H. Provide (3) adjustable shelves for bookshelf.
7. Height-adjustable work surface, high-pressure plastic laminate surface with thermoplastic edge banding, and motorized lift; 70" W x 29" D; standard electric height range of 27"- 46" H; work surface thickness: 1-1/4"; grommet on surface aligns with grommet in open shelf below to allow to wire management

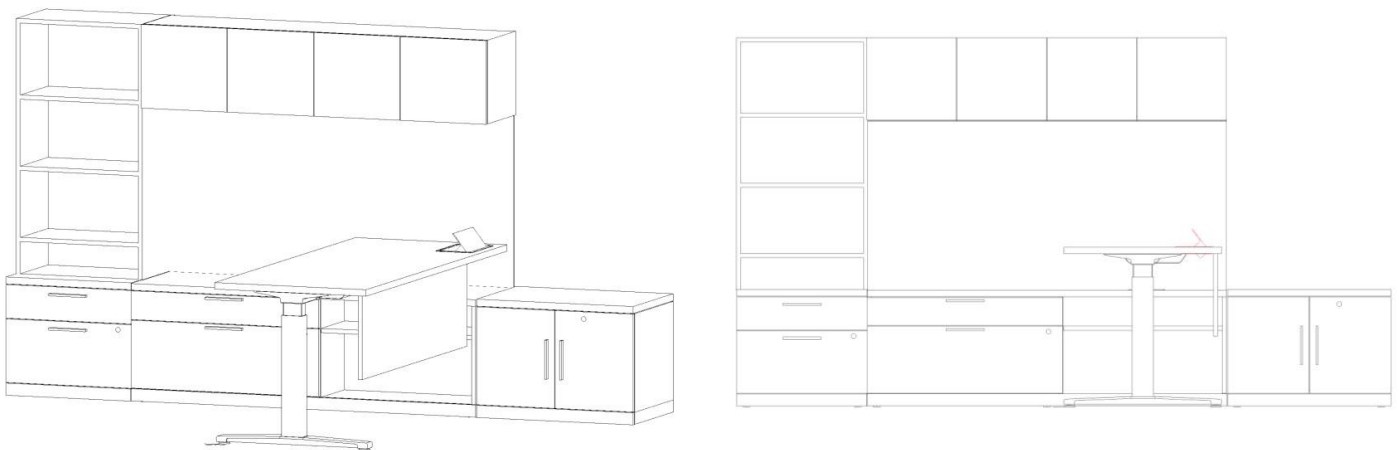

*Image shown is similar to Basis of Design product specified and is for reference only. Product requirements are listed.*

**TECHNICAL SPECIFICATIONS AND PERFORMANCE CRITERIA**

8. Overhead storage, 4-door, 66" W x 14-3/4" H x 14-3/4" D; wall mounted, hinged plastic laminate doors
9. Horizontal wire management trough, metal, full length of desk surface with easy access openings
10. Vertical wire manager, compatible with height-adjustable legs with easy access openings
11. Tackable surface mounted to wall; 66" W x 30" H x 3/4" D
12. Construction: High-pressure plastic laminate surfaces and storage, with PVC edge-banding; desk has metal C-leg configuration with adjustable leveling glides
13. Provide high pressure plastic laminate modesty panel full length of desk and at least 12" W for maximum privacy with use of motorized lift mechanism, mounted below desk surface
14. Motorized Lift mechanism with up/down touch switch control at front edge of worksurface
15. Under-overhead cabinet lighting, 18"W x 1-1/16"D x 3/4"H; LED light mounts under overhead storage unit; kit include 2 lights, 1 power supply, 2 cable management clips, a connector to join the two lights, and wood mounting brackets
16. Provide two grommets at each worksurface and minimum 24" long power strip
17. Finish: one high pressure plastic laminate color for all desk and storage surfaces, die-cast aluminum desk legs with nonslip rubber feet; vertical grain direction on vertical surfaces; grain direction on horizontal surfaces to run in the same direction.
18. Warranty: 12-year Parts & Labor Manufacturer's Warranty
19. BOD: Herman Miller Canvas Desking or Equal.



**TECHNICAL SPECIFICATIONS AND PERFORMANCE CRITERIA**

**DESKS**

**Item D04 Desk, Crew Chief Office Desk,**

1. Fixed height L-shape desk: Privacy panel between desks, panels for supporting overhead storage, combination closed/open frame panel along worksurface return, (1) free-standing box/box/file pedestal, (1) horizontal wire management trough, (1) 4-door overhead storage

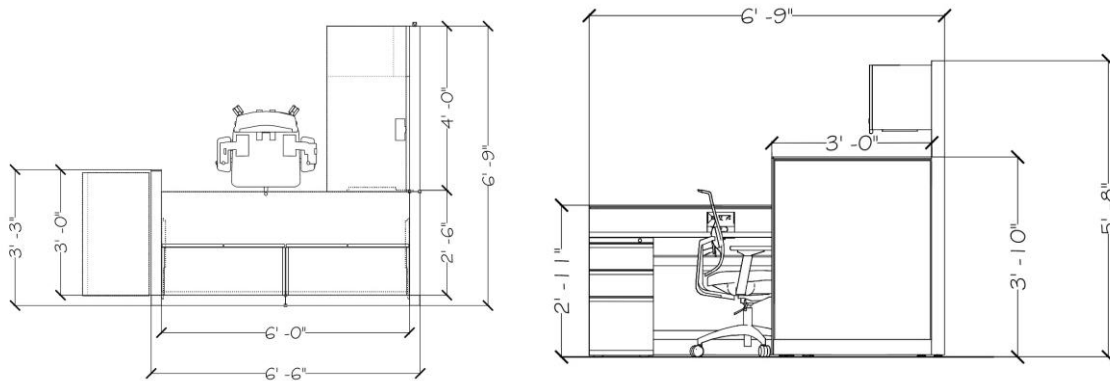

*Image shown is similar to Basis of Design product specified and is for reference only.  
Product requirements are listed.*

2. Overall Dimensions: 6'-6" W x 6'-9" L
3. L-shape worksurface: Fixed height, 30" D x 72" W; return 24" D x 48"; high-pressure plastic laminate surface with thermoplastic edge banding; provide four grommets total, worksurface thickness: 1-1/4" thick
4. Privacy panels: Monolithic, 46" H x 36" W x 3" D; non-powered, tackable acoustic fabric
5. Support panels for overhead storage: Monolithic, 68" H x 39" W x 3" D; non-powered, tackable acoustic fabric
6. Combination closed/open frame panel along worksurface return: 6'-9" L x 35" H; 3"D; open tiles in lower frames of panel for wall power access, upper frames are tackable acoustic fabric
7. Free-standing box/box/file storage: 15" W x 22" D x 25-7/8" H; powder coat painted metal case and drawer fronts with 3/8"H laminate top, finish to match worksurface; full-extension ball-bearing slides; 2-1/4"H base with leveling glides

**TECHNICAL SPECIFICATIONS AND PERFORMANCE CRITERIA**

8. Horizontal wire management trough: mounted to bottom perimeter of worksurface; powder coat painted metal finish
9. Overhead storage: 4-door, 66" W x 14-3/4" H x 14-3/4" D; hangs on panel frame, hinged powder coat painted case and doors
10. Construction: Powder coat painted metal storage, high-pressure plastic laminate desktop surface, tackable acoustic fabric panels
11. Warranty: 12-year Parts & Labor Manufacturer's Warranty
12. BOD: Herman Miller Canvas Desking or Equal.

**TECHNICAL SPECIFICATIONS AND PERFORMANCE CRITERIA**

**FILES**

**Item F01 Metal Lateral Files with Countertop**

1. Freestanding Lateral File: Three 12” drawers, with keyed lock and common top
2. Overall dimensions: 36" W x 17-7/8" D x 43"H
3. Standard inset pull, positive interlock system allows only one drawer open at a time; one lock controls all drawers
4. Frame base: 4-1/2”H, side to side filing railing in all drawers
5. Construction: Welded steel metal case and drawer fronts, powder coat metal finish, high density plastic laminate top; 1-1/4” thick top
6. Items F03, M01, and D01 must be from same manufacturer to match finishes.
7. Meet or exceed ANSI/BIFMA X5.9-2004 standards
8. Warranty: 12-year Parts & Labor Manufacturer’s Warranty
9. BOD: Herman Miller, Meridian Storage File Cabinets



*Image shown is similar to Basis of Design product specified and is for reference only. Product requirements are listed above.*

**TECHNICAL SPECIFICATIONS AND PERFORMANCE CRITERIA**

**FILES**

**Item F02 Map/Plan Room Flat Files**

1. Set of two 5-drawer high freestanding flat files stacked on a 6" base
2. Overall dimensions: 46" W x 35" D x 39" H
3. Drawers are 2.125"H x 43"W for maximum sheets sized 30"W x 42"L; hold 500 active or 1,000 inactive sheets; heavy duty drawers rails and side-roller assembly with ball bearings; positive closures and courtesy stops for safety keeps drawers closed
4. Metal base: 6"H x 46"W x 32"D, recessed design for toe space
5. Label holders, chrome drawer pulls, and antislip pads for stacking included
6. Rear hood and hinged front depressor protect sheets and prevent curling
7. Sturdy inner frame supports for stacking strength
8. Provide counterweight per manufacturer's recommendation.
9. Construction: Welded construction with double thick wraparound corners, powder-coated finish is safe for archiving
10. Warranty: 5 Year Limited
11. BOD: Gaylord Archival- Safco Flat Files or Equal



*Image shown is similar to Basis of Design product specified and is for reference only. Product requirements are listed above.*

**TECHNICAL SPECIFICATIONS AND PERFORMANCE CRITERIA**

**FILES**

**Item F03 Vertical Files**

1. Freestanding Vertical File: Four 12”H drawers, with keyed lock
2. Overall dimensions: 15"W x 23-7/8"D x 48-1/8"H
3. Standard inset pull, positive interlock system allows only one drawer open at a time; one lock controls all drawers
4. Frame base: 4-1/2”H, front facing vertical filing in all drawers
5. Construction: Welded steel metal case and drawer fronts, powder coat metal finish
6. Items F01, M01 must be from same manufacturer to match finishes
7. Meet or exceed ANSI/BIFMA X5.9-2004 standards
8. Warranty: 12-year Parts & Labor Manufacturer’s Warranty
9. BOD: Herman Miller, Meridian Storage File Cabinets or equal



*Image shown is similar to Basis of Design product specified and is for reference only.  
Product requirements are listed above.*

**TECHNICAL SPECIFICATIONS AND PERFORMANCE CRITERIA**

**FILES**

**Item F04 Vertical Files with Wardrobe**

1. Freestanding Vertical File and Wardrobe Cabinet: Four 12”H drawers, with keyed lock
2. Overall dimensions: 23-7/8”W x 23-7/8”D x 48-1/8”H
3. Bar pull, positive interlock system allows only one drawer open at a time; one lock controls all drawers and door
4. Frame base, 4-1/2”H; squared-edge top 1”H
5. Construction: Welded steel metal case with plastic laminate on exposed finished surfaces, laminate finish to match D03 finish.
6. Items F03, T06 and D03 must be from same manufacturer to match finishes
7. Meet or exceed ANSI/BIFMA X5.9-2004 standards
8. Warranty: 12-year Parts & Labor Manufacturer’s Warranty
9. BOD: Herman Miller, Meridian Vertical Tower with Wardrobe, or equal

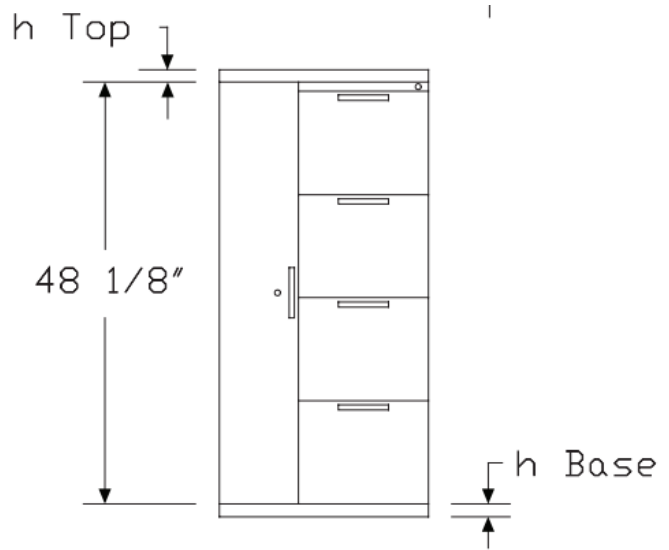

*Image shown is similar to Basis of Design product specified and is for reference only. Product requirements are listed above.*

**TECHNICAL SPECIFICATIONS AND PERFORMANCE CRITERIA**

**MISCELLANEOUS ITEMS**

**Item M01 Conference Room Credenza**

1. Freestanding Storage Credenza: enclosed 4-door storage, 1-1/4" thick single laminate top, painted steel case, laminate door fronts, locking; 2-1/4"H base with 1" leveling glides; interior includes (1) adjustable shelf on 1-1/4" increments; arc pull handles
2. Overall dimensions: 60" W x 20" D x 25-7/8" H
3. Construction: Steel case with smooth powder coated finish all interior and exterior exposed surfaces; plastic laminate top and doors; interior is painted metal with a metal shelf
4. Adjustable shelf, adjust in 1" increments
5. Continuous countertop, 1-1/4" thick
6. Warranty: 12-year Parts & Labor Manufacturer's Warranty
7. Item T02 must be from same manufacturer to match laminate finish
8. BOD: Herman Miller, Canvas Storage Credenza or Equal.

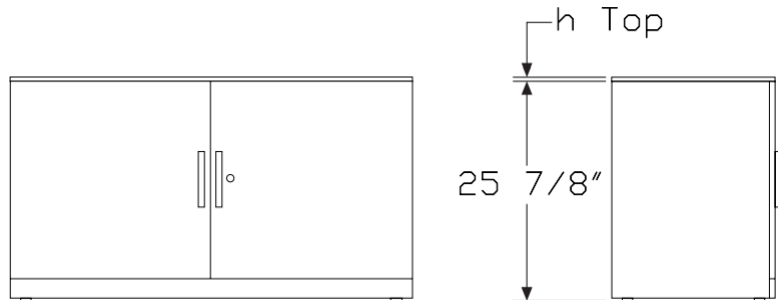

*Image shown is similar to Basis of Design product specified and is for reference only.  
Product requirements are listed above.*

**TECHNICAL SPECIFICATIONS AND PERFORMANCE CRITERIA**

**MISCELLANEOUS ITEMS**

**Item M02 Map/Plan Room Bookcase**

1. Free-standing metal bookcase with (3) metal adjustable shelves
2. Overall size: 36"W x 12"D x 52-1/2"H
3. Shelf Construction: Steel case and shelves, smooth powder coat paint finish
4. Metal adjustable shelves, adjust on 1" increments
5. 4-1/4"H base with adjustable glides
6. Items F01, F03 must be from same manufacturer to match finishes
7. Warranty: 12-year Parts & Labor Manufacturer's Warranty
8. BOD: Herman Miller, Meridian Storage or equal



*Image shown is similar to Basis of Design product specified and is for reference only. Product requirements are listed above.*



**TECHNICAL SPECIFICATIONS AND PERFORMANCE CRITERIA**

**MISCELLANEOUS ITEMS**

**Item M03 Roof Terrace Outdoor Picnic Umbrella**

1. Commercial Outdoor Umbrella: 7.5' canopy span with post for mounting in tables
2. Overall dimensions: 92" H x 90" W x 90" D
3. Commercial-grade outdoor fabric, 8-panel octagon canopy with custom multi-color brand logo printed on two panels, pantone matching colors; wind vents and fiberglass ribs
4. Aluminum Pole: 1.5" diameter; pop-up opening system
5. Solution-dyed acrylic outdoor fabric
6. Warranty: 1-year limited
7. BOD: Umbrella Source 7.5' Market Commercial Umbrella with custom logo or Equal



*Image shown is similar to Basis of Design product specified and is for reference only. Product requirements are listed above.*

**TECHNICAL SPECIFICATIONS AND PERFORMANCE CRITERIA**

**MISCELLANEOUS ITEMS**

**Item M04 Trash Receptacle**

1. Trash Receptacle: 23 gallon capacity; 11”W x 20”D x 30”H
2. Thin profile to fit in tight spaces
3. Built-in finger grips on top rim and handles on bottom for easy lifting and dumping
4. Construction: Heavy duty plastic, resists dents and corrosion
5. No lid or closure
6. Warranty: 1-Year Limited
7. BOD: Global Industrial Slim Trash Can



*Image shown is similar to Basis of Design product specified and is for reference only. Product requirements are listed above.*

**TECHNICAL SPECIFICATIONS AND PERFORMANCE CRITERIA**

**MISCELLANEOUS ITEMS**

**Item M05 Recycling Receptacle**

1. Recycling Receptacle: 23 gallon capacity; 11”W x 20”D x 30”H
2. Thin profile to fit in tight spaces
3. Built-in finger grips on top rim and handles on bottom for easy lifting and dumping
4. Universal recycling logo for clear identification
5. Construction: Heavy duty plastic, resists dents and corrosion
6. No lid or closure
7. Warranty: 1-Year Limited
8. BOD: Global Industrial Slim Recycling Can



*Image shown is similar to Basis of Design product specified and is for reference only. Product requirements are listed above.*

**TECHNICAL SPECIFICATIONS AND PERFORMANCE CRITERIA**

**MISCELLANEOUS ITEMS**

**Item M06 Deskside Recycling**

1. Recycling Receptacle: 28-1/8 quart capacity; 14-1/2"W x 10-1/2"D x 15"H
2. Universal recycling logo for clear identification
3. Rounded corners and curved lip for extra strength, raised-edge bottom for stability
4. Construction: Heavy duty plastic, resists dents and corrosion
5. No lid or closure
6. Warranty: 1-Year Limited
7. BOD: Global Industrial or Grainger or Equal.



*Image shown is similar to Basis of Design product specified and is for reference only. Product requirements are listed above.*

**TECHNICAL SPECIFICATIONS AND PERFORMANCE CRITERIA**

**MISCELLANEOUS ITEMS**

**Item M07 Deskside Trash Receptacle**

1. Trash Receptacle: 28 1/8 quart capacity; 14-1/2" W x 10-1/2"D x 15"H
2. Rounded corners and curved lip for extra strength, raised-edge bottom for stability
3. Construction: Heavy duty plastic, resists dents and corrosion
4. No lid or closure
5. Warranty: 1-Year Limited
6. BOD: Global Industrial or Grainger or Equal.



*Image shown is similar to Basis of Design product specified and is for reference only. Product requirements are listed above.*

**TECHNICAL SPECIFICATIONS AND PERFORMANCE CRITERIA**

**MISCELLANEOUS ITEMS**

**Item M08 Break Room/ Training Room Trash and Recycling**

1. Two-compartment Trash and Recycling Receptacle: 10 gallon capacity per compartment; 38”W x 30”H x 11”D
2. Thin profile to fit in tight spaces
3. Includes (2) polyethylene liner bag retainers and recycling and waste decals
4. Top opening to each compartment is oval shape for multi-stream waste; no lid closure
5. Hinged front cabinet door for access to bag retainers for emptying
6. Construction: Frame steel with polyurethane finish; side material power coat steel; top 1” MDF (formaldehyde free) with graphite powder coat finish
7. BOD: Peter Pepper Remix Multi-Stream Receptacle or Equal.



*Image shown is similar to Basis of Design product specified and is for reference only.  
Product requirements are listed above.*

**TECHNICAL SPECIFICATIONS AND PERFORMANCE CRITERIA**

**MISCELLANEOUS ITEMS**

**Item M09 LED Task Light with USB Charging Port**

1. LED Task Light: Full-range dimming capabilities, flexible arm with 360 degree rotation, 360 degree shade rotation, and 180 degree tilt; ADA Compliant Optical Switch, and USB charging port integrated in the base
2. Overall Dimensions: 5"W x 6"D x 16.5"H; when folded flat, profile is .75"H; cord length is 6' long
3. Voltage: 120-240V 60Hz
4. Power Consumption: 6W MAX
5. Color Temperature: 3000K
6. Luminosity: 325 Lumens; Luminaire Efficacy: 54 Lumens/Watt
7. Color Rendition Index: 90 CRI
8. 50K hour lifespan
9. Certifications; ETL, CE, RoHS
10. Warranty: 1 Year
11. BOD: Pablo, PIXO Lamp

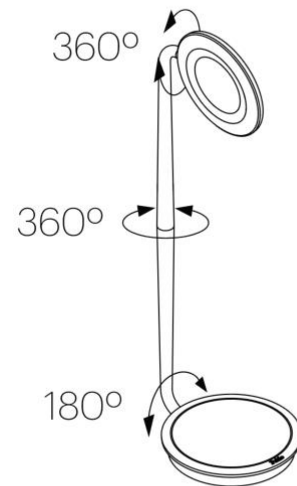

*Image shown is similar to Basis of Design product specified and is for reference only. Product requirements are listed above.*

**TECHNICAL SPECIFICATIONS AND PERFORMANCE CRITERIA**

**MISCELLANEOUS ITEMS**

**Item M10 Plastic Laminate Countertop**

1. Plastic Laminate Countertop, mounted on top of flat files
2. Overall Dimensions: 6'-2" W x 7'-2" D x 1.75"H
3. Construction: Plywood or MDF substrate with plastic laminate surface, squared edge with matching 3mm PVC edge banding; plastic laminate finish all exposed surfaces
4. Provide manufacturers full-range of plastic laminate color options for owner selection
5. Certification: AWI or WI Certified; Architectural Woodwork Standards Grade, Premium
6. Installation: Mount on top of F02 Flat Files, secure to wall and/or files with fasteners so that fasteners are hidden from view, caulk edge where countertop meets the wall; adhesives containing urea formaldehyde strictly prohibited; countertop overhangs edge of files 1" without obstructing use of file drawers
7. BOD: Herman Miller Countertop with Wilsonart Plastic Laminate finish



**TECHNICAL SPECIFICATIONS AND PERFORMANCE CRITERIA**

**TABLES**

**Item T01 Break/Training Room Table**

1. Rectangular Training Table: Flip top, nesting, T-leg, flexible modesty panel, powered with horizontal wire management trough, vertical cord cover, single circuit power entry, castors suitable for used on hard floors
2. Overall dimensions: 60” W x 24” D x 28-1/2” H
3. High pressure laminate top with thermoplastic edge banding, square edge; flipping mechanism mounted under top is accessible from front edge
4. Power cut-out in table for grommet-mount electrical distributor that is flush with surface; 12-3/4” L x 5” W x 4” D; one touch pop-up mechanism for access to power; power cord with plug end; provide 3 simplex receptacles, 2 data openings, and 2 USB charging ports; UL Listed
5. Castors suitable for use on hard floors, all four castors with locking abilities
6. Flexible modesty panel extends entire length of top and folds to allow tables to nest; aluminum top rail and attachment brackets
7. Horizontal wire management trough, 5-3/4” W x 4-1/4”D, extends entire length of top; made of metal and attaches to underside of top with easy access openings; mounting location coordinates with modesty panel; finish coordinates with finish of table leg
8. Vertical wire management cord cover, attaches to T-leg of table, 20” L, easy access openings for cable management; provide a cord cover on both legs of table; finish coordinates with finish of table leg



*Image shown is similar to Basis of Design product specified and is for reference only. Product requirements are listed above.*

**TECHNICAL SPECIFICATIONS AND PERFORMANCE CRITERIA**

9. Single circuit power entry, 10' long cord, 15-amp power entry provides power for single circuit electrical distributors; allows up to 8 single circuit distributors to be daisy chain connected in any order; includes standard attachment hardware
10. Construction: Metal T-leg with powder-coat finish, high pressure plastic laminate tabletop surface with thermoplastic edge banding; all metal components are the same finish and color
11. Warranty: 12-year Parts & Labor Manufacturer's Warranty
12. BOD: Herman Miller, Everywhere Nesting Table or Equal

**TECHNICAL SPECIFICATIONS AND PERFORMANCE CRITERIA**

**TABLES**

**Item T02 Conference Room Table**

1. Conference Table: 96” L x 48” W x 28.5” H, with cabinet base; plastic laminate surfaces; concealed power and data grommet mounted bucket, power module, leveling glides
2. Cabinet base with removable cabinet door for access to wire management; coordinates with metal trough mounted under table surface for complete concealment of wires
3. High pressure plastic laminate tabletop with thermoplastic knife-cut edge; (1) center cut-out in table for concealed power and data grommet
4. Concealed power and data grommet mounted bucket; lid conceals receptacles; coordinates with undersurface trough for wire management; (4) pass-through openings for data cords to be routed into bucket
5. Power Module: Mounts inside grommet mounted bucket; module is powered with standard power cord with plug end; (4) AC simplex receptacles and (4) USB receptacles; 24’ long cord length
6. Construction: Plastic laminate table and cabinet base surfaces; powder coat painted metal panel on cabinet base and under table surface manages and conceals wires, and allows access to power.
7. Warranty: 12-year Parts & Labor Manufacturer’s Warranty
8. BOD: Herman Miller Headway Conference Table or Equal.



*Image shown is similar to Basis of Design product specified and is for reference only. Product requirements are listed above.*

**TECHNICAL SPECIFICATIONS AND PERFORMANCE CRITERIA**

**TABLES**

**Item T03 Map/Plan Room Work Table**

1. Work Table: 54”D x 60”L x 36”H; counter-height with open cubby storage below worksurface, locking castors
2. High pressure plastic laminate worksurface with matching PVC edge-banding; worksurface can be removed without tools to fit through doorways
3. Open cubby storage below worksurface, 2’x2’ open cubbies, (4) cubbies open face on two opposite sides of table; (2) cubby units separate when worksurface is removed so that table can fit through doorways
4. 3” Industrial-grade castors, all castors lockable
5. Construction: Powder-coat steel base and cubbies with 18-gauge reinforcement members; high pressure laminate worksurface
6. Warranty: 15-year Limited
7. BOD: KI Ruckus Work Table or Equal.



*Image shown is similar to Basis of Design product specified and is for reference only. Product requirements are listed above.*

**TECHNICAL SPECIFICATIONS AND PERFORMANCE CRITERIA**

**TABLES**

**Item T04 Roof Terrace Outdoor Picnic Table**

1. Steel Frame Table: 86” DIA x 33”H, (4) attached contoured seats with backs
2. Construction: 2” diameter steel tubing supports table top and attached seats, perforated heavy gauge steel table top and seats with powder coat painted finish
3. Umbrella hole in table top and holder in base for umbrella by others to be compatible with M03
4. Freestanding with glides
5. Product weight: 211lbs
6. BOD: Landscape Forms Carousel Picnic Table or Equal.



*Image shown is similar to Basis of Design  
product specified and is for reference only.  
Product requirements are listed above.*

**TECHNICAL SPECIFICATIONS AND PERFORMANCE CRITERIA**

**TABLES**

**Item T05 Roof Terrace ADA Picnic Table**

1. Steel Frame Table: 86” DIA x 33”H, (3) attached contoured seats with backs
2. Construction: 2” diameter steel tubing supports tabletop and attached seats, perforated heavy gauge steel table top and seats with powder coat painted finish
3. Umbrella hole in table top and holder in base for umbrella by others to be compatible with M03
4. Surface mounted with bolts into floor
5. BOD: Landscape Forms Carousel Picnic Table or Equal.
6. ADA Compliant, opening on side for wheelchair accessibility
7. Product weight: 172lbs
8. BOD: Landscape Forms Carousel Picnic Table or Equal.



*Image shown is similar to Basis of Design product specified and is for reference only. Product requirements are listed above.*

**TECHNICAL SPECIFICATIONS AND PERFORMANCE CRITERIA**

**TABLES**

**Item T06 Supervisor Office Round Table**

1. Round Pedestal Table: 30" DIA x 29"H
2. Construction: Metal steel pedestal supports high pressure plastic laminate table top with matching PVC edge banding
3. Adjustable height glides with ½" leveling range
4. Finishes to match item D03



*Image shown is similar to Basis of Design product specified and is for reference only.  
Product requirements are listed above.*

**TECHNICAL SPECIFICATIONS AND PERFORMANCE CRITERIA**

**TABLES**

**Item T07 Crew Chief Office Round Table**

1. Round Pedestal Table: 48" DIA x 29"H
2. Construction: metal steel pedestal supports high pressure plastic laminate table top with matching PVC edge banding
3. Adjustable height glides with ½" leveling range
4. Finishes to match item D04



*Image shown is similar to Basis of Design  
product specified and is for reference only.  
Product requirements are listed above.*



**FAIRFAX COUNTY WATER AUTHORITY, CENTRAL MAINTENANCE FACILITY  
2926, 2930, 2934 INDUSTRY LANE, FAIRFAX, VA 22031**

**TECHNICAL SPECIFICATIONS AND PERFORMANCE CRITERIA**

**End of Section**