

**FAIRFAX COUNTY WATER AUTHORITY, WILLARD ROAD MAINTENANCE FACILITY
14925 WILLARD ROAD, CHANTILLY, VA 20151**

TECHNICAL SPECIFICATIONS AND PERFORMANCE CRITERIA

This specification establishes the minimum requirements for the acquisition and installation of the following appliances: task and training seating, training and breakroom tables, adjustable height desks, filing and storage, fixed height desks, and miscellaneous accessory items. Provide in accordance with the furniture plan, Basis of Design as shown and specified herein.

GENERAL SPECIFICATION NOTES:

- A. Provide quantity (1) item M01 and (1) item M02 at every desk.
- B. Provide quantity (11) item M12 to be installed at workstations determined by owner. Notify owner when monitor arms are ready to be installed.
- C. All desk wiring must be concealed in wire management troughs or with wire management sleeves.
- D. All outlets must remain accessible to the owner for connecting to computers and desk equipment. At locations where outlets may be blocked by furniture and inaccessible to the owner, notify the owner and architect prior to completion of installation. Supplier to modify standard layout as needed to accommodate outlet locations.
- E. All desk grommet locations to be determined in field by owner and architect. Notify owner and architect when grommets are ready to be installed.
- F. Provide full range of manufacturers plastic laminate and powder coat paint finish options at no extra charge to the owner. Final finish selections of all items shall be made by the owner; coordinate furniture finish meeting with the owner prior to final ordering of furniture.
- G. All desks, desk storage, bookcases, wardrobe towers, vertical file cabinets, and lateral file cabinets shall be provided by a single manufacturer (Items D01, D02, D03, D04, D05, D06, D07, D08, D09, D10, D11, S01, S02, S03, S04, S05, S06, S07, S08, S11).
- H. All storage shall have locks and be keyed alike per private office or workstation as applicable. Coordinate the keying of all storage with owner and architect prior to completion.
- I. Item M13 locations to be determined in field by owner and architect. Notify owner and architect when mounting brackets are ready to be installed.
- J. Prior to final ordering of furniture, Furniture Dealer must schedule a building tour with the owner and architect to field-verify the power and data locations.

TECHNICAL SPECIFICATIONS AND PERFORMANCE CRITERIA

SEATING

Item C01 Task Chair

1. Task Chair: Adjustable arms, adjustable height, casters
2. Overall dimensions: 25.75"W x 25"D x 37"H
3. Standard cylinder 5" casters
4. Chair Width: 25.75" with arms
5. Base Size: 24"
6. Seat Height Range: 15.63" – 20.75"
7. Seat construction: contoured seat cushion with mesh seat with frameless front edge
8. Back construction: tri-panel, non-stretch mesh with automatic lumbar support, 17 degree recline + 8 degree backrest tilt
9. Maximum User Weight: 300lbs
10. Finish: Aluminum base, mesh back, mesh seat
11. Warranty: 7 Years (Parts and Components) 3 Years (Arm Pads and Textiles), Single Shift Warranty
12. Basis of Design: Humanscale Diffrient World One Task Chair or Equal.



Image shown is similar to Basis of Design product specified and is for reference only. Product requirements are listed above.

TECHNICAL SPECIFICATIONS AND PERFORMANCE CRITERIA

SEATING

Item C02 Task Chair Stool

1. Task Chair Stool: Adjustable arms, adjustable height, casters
2. Overall dimensions: 25.75"W x 25"D x 38-1/8" – 45-5/8"H
3. 8" High cylinder with 18" footring
4. Chair Width: 25.75" with arms
5. Base Diameter: 25"
6. Seat Height Range: 20.5"-28.5"
7. Seat construction: contoured seat cushion with upholstered mesh seat with frameless front edge
8. Back construction: tri-panel, non-stretch mesh with automatic lumbar support
9. Maximum User Weight: 300lbs
10. Finish: Aluminum base, mesh back, mesh seat
11. Warranty: 7 Years (Parts and Components) 3 Years (Arm Pads and Textiles), Single Shift Warranty
12. Basis of Design: Humanscale Diffrient World One High Task Chair or Equal.



Image shown is similar to Basis of Design product specified and is for reference only. Product requirements are listed above.

TECHNICAL SPECIFICATIONS AND PERFORMANCE CRITERIA

SEATING

Item C03 Occasional Chair, Stacking, Glides, Upholstered, Mesh Back

1. Multi-purpose Training Chair: Stackable, fixed arms, and cantilever base
2. Overall dimensions: 23.23” W x 21.19” D x 36.68” H
3. Frame construction: 100% recyclable aluminum tubular frame, welded
4. Seat construction: Contoured seat cushion with upholstered mesh seat with frameless front edge
5. Back construction: Tri-panel non-stretch mesh, with automatic lumbar support, and 8 degree tilt
6. Arms: Fixed tubular frame with urethane arm caps
7. Upholstery shall be bleach cleanable non-woven polyurethane material, water repellent, 300,000 double rubs (Wyzenbeek), 160,000 rubs (Martindale).
8. Maximum User Weight: 300lbs
9. Finish: Chrome 3 plated metal finish on frame, non-woven upholstered seat, mesh back
10. Warranty: 15-years, Fabric/Cushions: 5 years, single shift
11. Basis of Design: Human Scale Liberty Occasional or Equal.



Image shown is similar to Basis of Design product specified and is for reference only. Product requirements are listed above.

TECHNICAL SPECIFICATIONS AND PERFORMANCE CRITERIA

SEATING

Item C04 Bariatric Chair, Glides, Upholstered, Non-Woven Vinyl Seat and Back

1. Bariatric Chair: guest chair with cushion seat and back with non-woven vinyl fabric finish, and arms.
2. Overall dimensions: 32" W x 25" D x 35" H
3. Seat dimensions: 30" W x 20" D
4. Back dimensions: 30" W x 15" H
5. Construction: 16-gauge high-strength tubular steel legs, 14-gauge tubular steel side and cross members, and 11-gauge steel gussets at the front legs. All joints manually welded. Epoxy powder-coat paint finish all exposed surfaces with end caps made of molded plastic to match frame color. Seat and back made of plywood with urethane foam cushion and non-woven vinyl fabric finish. Back is raised above seat cushion to allow for wipe-out space at the back of the seat.
6. Maximum User Weight: 750 lbs
7. Upholstery shall be bleach cleanable non-woven polyurethane material, water repellent, 100,000 double rubs (Wyzenbeek). Provide a minimum of 30 non-woven vinyl color options for the owner to select from, from the following approved fabric manufacturers: Pallas, DesignTex, Architex, CF Stinson, Momentum Textiles, Maharam, HBF Textiles, and Knoll Textiles.
8. Finish: Urethane arms and legs, non-woven upholstered seat and back
9. Warranty: Lifetime Warranty
10. Basis of Design: KI Katera XL Bariatric Guest Chair or Equal.



Image shown is similar to Basis of Design product specified and is for reference only. Product requirements are listed above.

**FAIRFAX COUNTY WATER AUTHORITY, WILLARD ROAD MAINTENANCE FACILITY
14925 WILLARD ROAD, CHANTILLY, VA 20151**

TECHNICAL SPECIFICATIONS AND PERFORMANCE CRITERIA

8. Height-adjustable work surface, 1" thick x 70"W x 34"D high-pressure laminate surface with 3mm PVC edge-banding. Grain direction runs left to right.
9. Overhead storage, (1) two-door, 36"W x 15"D x 17-3/16"H. Soft close hinge.
10. Horizontal wire management trough, metal, full length of desk surface with easy access openings
11. Reference item M11 vertical wire manager compatible with item M10 height adjustable legs with easy access openings and install at this desk.
12. Construction: Particle board core with high-pressure laminate surfaces and with PVC edge-banding. Adjustable leveling glides at each storage return.
13. Provide high-pressure laminate modesty panel full length of desk; 3/4" thick x 20-3/4"H; mounted below desk surface leaving 6" between panel and desktop for mounting monitor arm
14. Provide (2) 2" round plastic grommets per desk. Location to be determined in field.
15. Finish: high pressure plastic laminate for all desk and storage surfaces, vertical grain direction on vertical surfaces; grain direction on horizontal surfaces to run in the same direction.
16. All desk storage keyed alike with storage pieces in room
17. Warranty: 12 Years
18. Basis of Design: Desk and Storage, KI Likha Casegoods or Equal.

**FAIRFAX COUNTY WATER AUTHORITY, WILLARD ROAD MAINTENANCE FACILITY
14925 WILLARD ROAD, CHANTILLY, VA 20151**

TECHNICAL SPECIFICATIONS AND PERFORMANCE CRITERIA

8. Height-adjustable work surface: 1" thick x 70" W x 34" D high-pressure laminate surface with 3mm PVC edge-banding. Grain direction runs left to right.
9. Overhead storage, (1) two-door, 36" W x 15" D x 17-3/16"H. Soft close hinge. Vertical grain direction.
10. Horizontal wire management trough, metal, full length of desk surface with easy access openings. Concealed behind modesty panel.
11. Reference item M11 vertical wire manager compatible with item M10 height adjustable legs with easy access openings and install at this desk.
12. Construction: Particle board core with high-pressure laminate surfaces and with PVC edge-banding. Adjustable leveling glides at each storage return.
13. Provide high-pressure laminate modesty panel full length of desk ; 3/4" thick x 20-3/4"H; mounted below desk surface leaving 6" between panel and desktop for mounting monitor arm.
14. Provide (2) 2" round plastic grommets per desk. Location to be determined in field.
15. Finish: high pressure plastic laminate for all desk and storage surfaces, vertical grain direction on vertical surfaces; grain direction on horizontal surfaces to run in the same direction.
16. All desk storage keyed alike with storage pieces in room
17. Warranty: 12 Years
18. Basis of Design: KI Likha Casegoods or Equal.

**FAIRFAX COUNTY WATER AUTHORITY, WILLARD ROAD MAINTENANCE FACILITY
14925 WILLARD ROAD, CHANTILLY, VA 20151**

TECHNICAL SPECIFICATIONS AND PERFORMANCE CRITERIA

DESKS

Item D03 Desk, WH Super Desk (Right-side Return)

1. Height-adjustable desk no overhead storage: (1) Box/file low storage, (1) low credenza open shelf, (1) bookshelf and box/file storage combination, (1) horizontal wire management trough, (1) vertical cable manager
2. Overall Dimensions: 9'W x 5'-10"D x 6'-1-5/8"H
3. Box/File low storage: 36"W x 23-1/4"D x 20-3/4"H
4. Low credenza open shelf : 36"W x 24"D x 20-3/4"H. Cavity at the back of the open shelf is large enough to accommodate item M10 and M11. Removable panel at the back of the shelf to allow for quick access to wiring in cavity.
5. Bookshelf and box/file storage combination: 36"W x 14-1/4"D x 52-7/8"H; box/file is 20-3/4"H; bookshelf attaches on top for a total height of 6'-1-5/8"H. Provide (3) adjustable shelves for bookshelf.
6. Height-adjustable work surface, 1" thick x 70"W x 34"D high-pressure laminate surface with 3mm PVC edge-banding. Grain direction runs left to right.
7. Horizontal wire management trough, metal, full length of desk surface with easy access openings. Concealed behind modesty panel.
8. Reference item M11 vertical wire manager compatible with item M10 height adjustable legs with easy access openings and install at this desk.
9. Construction: Particle board core with high-pressure laminate surfaces and with PVC edge-banding. Adjustable leveling glides at each storage return.

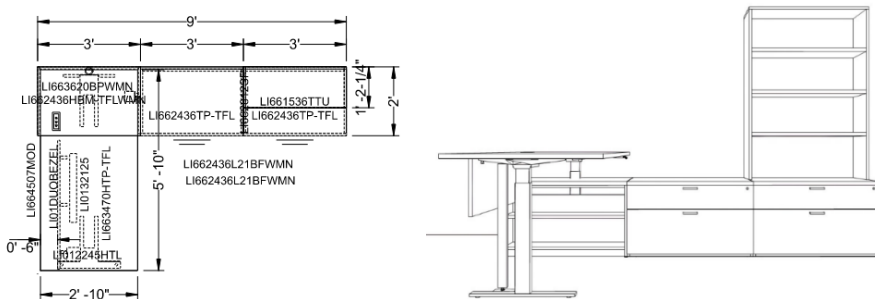

Image shown is similar to Basis of Design product specified and is for reference only. Product requirements are listed above.

**FAIRFAX COUNTY WATER AUTHORITY, WILLARD ROAD MAINTENANCE FACILITY
14925 WILLARD ROAD, CHANTILLY, VA 20151**

TECHNICAL SPECIFICATIONS AND PERFORMANCE CRITERIA

10. Provide high-pressure laminate modesty panel full length of desk; 36"W x 3/4"D x 20-3/4"H; mounted below desk surface leaving 6" between panel and desktop for mounting monitor arm and cable management
11. Provide (2) 2" round plastic grommets per desk. Location to be determined in field.
12. Finish: high pressure plastic laminate for all desk and storage surfaces, vertical grain direction on vertical surfaces; grain direction on horizontal surfaces to run in the same direction.
13. All desk storage keyed alike with storage pieces in room
14. Warranty: 12 Years
15. Basis of Design: KI Likha Casegoods or Equal.

TECHNICAL SPECIFICATIONS AND PERFORMANCE CRITERIA

DESKS

Item D04 Fixed Height Desk

1. Fixed height desk: laminate worksurface, metal support legs, (1) box/box/file storage
2. Overall Dimensions: 72"W x 30"D x 30"H
3. Worksurface: 1" thick high-pressure plastic laminate with matching PVC edge band, BIFMA Compliant, grain to run horizontally
4. Box/box/file: 15"W x 27-5/8"D x 27-5/8"H, mobile pedestal- box/box/file on casters, keyed individually
5. Construction: Painted steel metal frame, modular seated height metal support leg. Painted steel metal storage pedestal.
6. Base Finish: Powder-coated painted metal
7. Exceeds rigid quality and testing standards on BIFMA
8. Warranty: 12 Years
9. Basis of Design: KI Likha Caseloads or Equal



Image shown is similar to Basis of Design product specified and is for reference only. Product requirements are listed above.

TECHNICAL SPECIFICATIONS AND PERFORMANCE CRITERIA

DESKS

Item D05 L-Shape Fixed Height Metal Desk (Left-Side Return)

1. Fixed height desk: metal support legs, (1) box/box/file storage, no overhead storage
2. Overall Dimensions: 72"W x 30"D x 30"H worksurface; 42"W x 30"D x 30"H left return
3. Worksurface: 1-1/4" thick high-pressure plastic laminate with matching PVC edge band
4. Box/box/file supporting pedestal 15"W x 27-5/8"D x 27-5/8"H, mobile on caster
5. Construction: welded steel shell and panels, painted steel metal frame, metal closed support leg, full-length metal modesty panel, laminate worksurface
6. Provide (2) 2" round plastic grommets per desk. Location to be determined in field.
7. Base Finish: Powder-coated painted metal
8. Exceeds rigid quality and testing standards of BIFMA and GSA
9. Desk storage keyed alike with quantity (1) item S-02.
10. Warranty: Lifetime Warranty
11. Basis of Design: KI 700 Series Desking System or Equal.

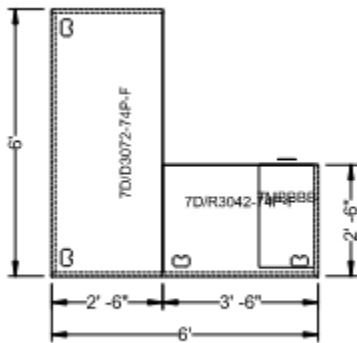

Image shown is similar to Basis of Design product specified and is for reference only. Product requirements are listed above.

TECHNICAL SPECIFICATIONS AND PERFORMANCE CRITERIA

DESKS

Item D06 Fleet Tech, L-Shape Fixed Height Metal Desk (Right-Side Return)

1. Fixed height desk: metal support legs, (1) box/box/file storage, no overhead storage
2. Overall Dimensions: 72"W x 30"D x 30"H worksurface; 42"W x 30"D x 30"H right return
3. Worksurface: 1" thick high-pressure plastic laminate with matching PVC edge band
4. Box/box/file supporting pedestal 15"W x 27-5/8"D x 27-5/8"H, mobile on casters
5. Construction: Painted steel metal frame, metal closed support leg, full-length metal modesty panel
6. Provide (2) 2" round plastic grommets per desk. Location to be determined in field.
7. Base Finish: Powder-coated painted metal
8. Exceeds rigid quality and testing standards of BIFMA and GSA
9. Desk storage keyed alike with quantity (1) item S-02.
10. Warranty: Lifetime Warranty
11. Basis of Design: KI 700 Series Desking System or Equal.

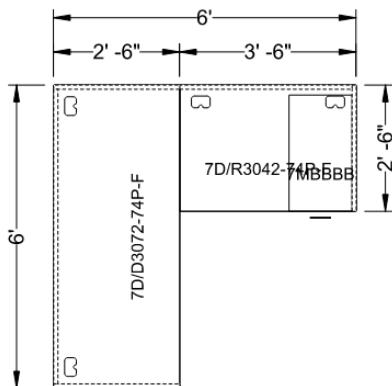

*Image shown is similar to Basis of Design product specified and is for reference only.
Product requirements are listed above.*

TECHNICAL SPECIFICATIONS AND PERFORMANCE CRITERIA

DESKS

Item D07 Desk, “Hoteling” Office 210 L-Desk

1. Fixed height L-shape desk: Privacy panel between desks, combination closed/open frame panel along worksurface return, (1) free-standing box/box/file pedestal, (1) horizontal wire management trough.
2. Overall Dimensions: 6’-7”W x 6’-4”D x 4’H
3. Box/box/file supporting pedestal, 15”W x 21-5/8”D x 27-7/8”H, keyed lock
1. L-shape worksurface: 72”W x 78”D x 29 1/8”H x 1-1/4” thick , Main worksurface depth 30”, Return desk depth 24” ; high pressure plastic laminate surface; Provide (4) 2” round plastic grommets per desk., location to be determined in field.
4. Worksurface Privacy Panel: Monolithic, 36”W x 2”D x 48”H; non-powered, tackable acoustic fabric
5. Right Return panel; 6’-4”W x 2”D x 48”H; tackable fabric above worksurface, open tiles below worksurface for access to wall power
6. Left side panel: Monolithic, 36” W x 2” D x 48”H; powered
7. Horizontal wire management trough: mounted on bottom perimeter of worksurface; powder coat painted metal finish

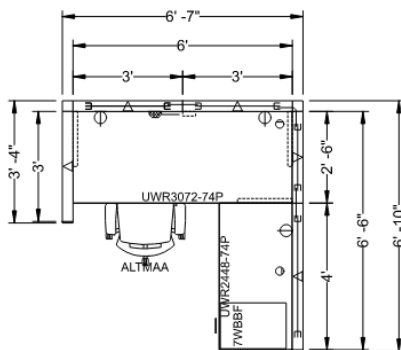

*Image shown is similar to Basis of Design product specified and is for reference only.
Product requirements are listed above.*

**FAIRFAX COUNTY WATER AUTHORITY, WILLARD ROAD MAINTENANCE FACILITY
14925 WILLARD ROAD, CHANTILLY, VA 20151**

TECHNICAL SPECIFICATIONS AND PERFORMANCE CRITERIA

8. Construction: Construction: Panels consist of 16-gauge steel tubing, vertical steel posts, top cap mounting clip channel to route data cables, glide housing, glides, and wire mounting bracket at bottom and beltway height raceway for attached 10-wire rigid wireways. Tile inserts are fabric and steel as indicated in locations above. Powder coat painted finish all exposed metal.
9. Finish: high pressure plastic laminate for desk worksurface and plastic laminate panel, vertical grain direction on vertical surfaces; grain direction on horizontal surfaces to run in the same direction.
10. Desks in room individually keyed.
11. Warranty: Lifetime Warranty
12. Basis of Design: KI Unite Panel System or Equal.

**FAIRFAX COUNTY WATER AUTHORITY, WILLARD ROAD MAINTENANCE FACILITY
14925 WILLARD ROAD, CHANTILLY, VA 20151**

TECHNICAL SPECIFICATIONS AND PERFORMANCE CRITERIA

DESKS

Item D08 Desk, Crew Chief L-Desk, (Left-Side Return)

1. Fixed height desk: metal support legs, (1) box/box/file storage, overhead storage
2. Overall Dimensions: 6'-7" W x 6'-10" D x 5'-4" H
3. L-shape Worksurface: Fixed height, 1" thick x 72" W x 30" D; return 48" W x 24" D ; high-pressure plastic laminate with matching PVC edge band
4. Overhead mounted panels: Monolithic, 36" W x 2" D x 64" H; powered, tackable acoustic fabric, standard base raceway to allow for distribution of power and data on both sides of panel.
5. Overhead storage: 36"W x 16-1/2"H x 14-1/2"D; steel door, mounts into slots in vertical post; overheads to be the same width as panel mounted to; allows for vertical adjustment in 1" increments; steel bottom and top shelf, end panels and front with powder-coated finish; allows shelf dividers; shelf depth is 13-1/4"
6. Right side panel: Monolithic, 40" W x 2" D x 40"H; powered, high-pressure laminate, standard base raceway to allow for distribution of power and data on both sides of panel.
7. Left return side panel: 6'-10" L x 3'-4" H; 2" D; powered, tackable acoustic fabric, standard base raceway to allow for distribution of power and data on both sides of panel.
8. Box/box/file supporting pedestal, 15" W x 21-5/8" D x 27-7/8" H

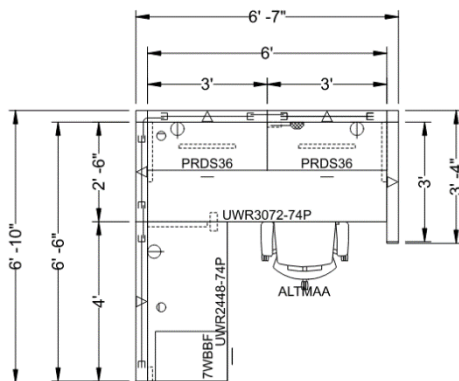

Image shown is similar to Basis of Design product specified and is for reference only. Product requirements are listed above.

TECHNICAL SPECIFICATIONS AND PERFORMANCE CRITERIA

9. Power: Desk system plugs into wall; Provide power at desk surface for computer and equipment. Base height power 10-wire rigid wireway with 72" L infeed conduit. Duplex receptacles snap fit into 10-wire rigid wireways in the panels with 20 amp capacity.
10. Horizontal wire management trough: mounted on bottom perimeter of worksurface; powder coat painted metal finish.
11. Base Raceway Trim: 5-5/16" H x width of the panel. Includes 2-1/6" x 7-5/8" knockouts to accommodate electrical receptacles and data jacks. Accepts rigid wireways and data cables with removable panel for easy access to wiring.
12. Construction: Panels consist of 16-gauge steel tubing, vertical steel posts, top cap mounting clip channel to route data cables, glide housing, glides, and wire mounting bracket at bottom and beltway height raceway for attached 10-wire rigid wireways. Tile inserts are fabric and steel as indicated in locations above. Powder coat painted finish all exposed metal. Provide (2) 2" round plastic grommets per desk. Location to be determined in field.
13. Exceeds rigid quality and testing standards of BIFMA and GSA
14. Finish: high pressure plastic laminate for desk worksurface and plastic laminate panel, vertical grain direction on vertical surfaces; grain direction on horizontal surfaces to run in the same direction.
15. Desk storage keyed individually.
16. Warranty: Lifetime Warranty
17. Basis of Design: KI Unite Panel System or Equal

TECHNICAL SPECIFICATIONS AND PERFORMANCE CRITERIA

DESKS

Item D09 Desk, Crew Chief L-Desk, (Right-Side Return)

1. Fixed height desk: metal support legs, (1) box/box/file storage, overhead storage
2. Overall Dimensions: 6'-7"W x 6'-10"D x 5'-4"H
3. L-shape Worksurface: Fixed height, 1" thick x 72"W x 30"D; return 48"W x 24"D ; high-pressure plastic laminate with matching PVC edge band
4. Overhead mounted panels: Monolithic, 6'-7"W x 2"D x 64"H; powered, tackable acoustic fabric, standard base raceway to allow for distribution of power and data on both sides of panel.
5. Overhead storage: 36"W x 16-1/2"H x 14-1/2"D; steel door, mounts into slots in vertical post; overheads to be the same width as panel mounted to; allows for vertical adjustment in 1" increments; steel bottom and top shelf, end panels and front with powder-coated finish; allows shelf dividers; shelf depth is 13-1/4"
6. Left side panel: Monolithic, 40"W x 2"D x 40"; powered, high-pressure laminate
7. Right side return panel: 6'-10"L x 3'-4"H x 2"D; tackable acoustic fabric, standard base raceway to allow for distribution of power and data on both sides of panel.
8. Box/box/file supporting pedestal, 15"W x 21-5/8"D x 27-7/8"H

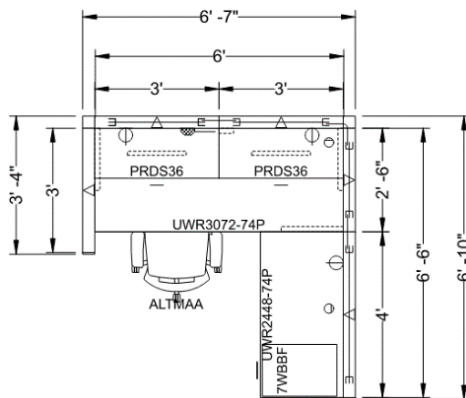

Image shown is similar to Basis of Design product specified and is for reference only. Product requirements are listed above.

TECHNICAL SPECIFICATIONS AND PERFORMANCE CRITERIA

9. Power: Desk system plugs into wall; Provide power at desk surface for computer and equipment. Base height power 10-wire rigid wireway with 72" L infeed conduit. Duplex receptacles snap fit into 10-wire rigid wireways in the panels with 20 amp capacity.
10. Horizontal wire management trough: mounted on bottom perimeter of worksurface; powder coat painted metal finish.
11. Base Raceway Trim: 5-5/16" H x width of the panel. Includes 2-1/6" x 7-5/8" knockouts to accommodate electrical receptacles and data jacks. Accepts rigid wireways and data cables with removable panel for easy access to wiring.
12. Construction: Panels consist of 16-gauge steel tubing, vertical steel posts, top cap mounting clip channel to route data cables, glide housing, glides, and wire mounting bracket at bottom and beltway height raceway for attached 10-wire rigid wireways. Tile inserts are fabric and steel as indicated in locations above. Powder coat painted finish all exposed metal.
13. Provide (2) 2" round plastic grommets per desk. Location to be determined in field.
14. Exceeds rigid quality and testing standards of BIFMA and GSA
15. Finish: high pressure plastic laminate for desk worksurface and plastic laminate panel, vertical grain direction on vertical surfaces; grain direction on horizontal surfaces to run in the same direction.
16. Desk storage keyed individually.
17. Connecting desks may share panels, refer to plans for layout and orientation.
18. Warranty: Lifetime Warranty
19. Basis of Design: KI Unite Panel System or Equal

TECHNICAL SPECIFICATIONS AND PERFORMANCE CRITERIA

DESKS

Item D10 Desk, Permit Tech Desk (Left-side Return)

1. Height-adjustable desk no overhead storage: (1) Box/file low storage, (1) low credenza open shelf, (1) bookshelf and box/file storage combination, (1) horizontal wire management trough, (1) vertical cable manager
2. Overall Dimensions: 9'W x 5'-10" D x 6'-1-5/8"H
3. Box/File low storage: 36" W x 23-1/4" D x 20-3/4"H
4. Low credenza open shelf: 36" W x 24" D x 20-3/4"H; cavity at the back of the open shelf is large enough to accommodate item M10 and M11. Removable panel at the back of the shelf to allow for quick access to wiring in cavity.
5. Bookshelf and box/file storage combination: 36" W x 14-1/4" D x 52-7/8"H; box/file is 20-3/4"H; bookshelf attaches on top for a total of 6'-1-5/8" H. Provide (3) adjustable shelves for bookshelf.
6. Height-adjustable work surface, 1" thick x 70" W x 34" D high-pressure laminate surface with 3mm PVC edge-banding. Grain direction runs left to right.

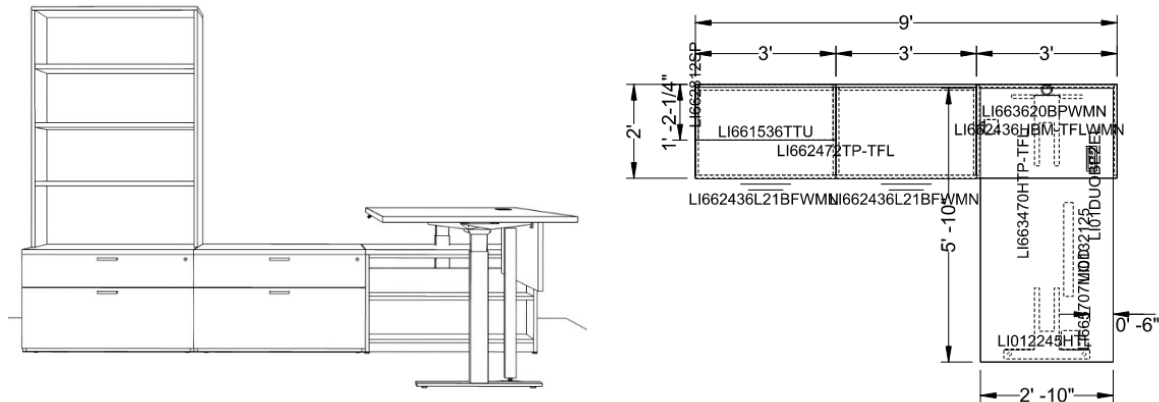

Image shown is similar to Basis of Design product specified and is for reference only. Product requirements are listed above.

**FAIRFAX COUNTY WATER AUTHORITY, WILLARD ROAD MAINTENANCE FACILITY
14925 WILLARD ROAD, CHANTILLY, VA 20151**

TECHNICAL SPECIFICATIONS AND PERFORMANCE CRITERIA

7. Horizontal wire management trough, metal, full length of desk surface with easy access openings. Concealed behind modesty panel.
8. Reference item M11 vertical wire manager compatible with item M10 height adjustable legs with easy access openings and install at this desk.
9. Construction: Particle board core with high-pressure laminate surfaces and with PVC edge-banding. Adjustable leveling glides at each storage return.
10. Provide high-pressure laminate modesty panel full length of desk; 3/4" thick x 20-3/4"H; mounted below desk surface leaving 6" between panel and desktop for mounting monitor arm
11. Provide (2) 2" round plastic grommets per desk. Location to be determined in field.
12. Finish: high pressure plastic laminate for all desk and storage surfaces, vertical grain direction on vertical surfaces; grain direction on horizontal surfaces to run in the same direction.
13. Desk storage keyed alike with quantity (1) item S-02.
14. Warranty: 12 Years
15. Basis of Design: KI Likha Casegoods or Equal.

**FAIRFAX COUNTY WATER AUTHORITY, WILLARD ROAD MAINTENANCE FACILITY
14925 WILLARD ROAD, CHANTILLY, VA 20151**

TECHNICAL SPECIFICATIONS AND PERFORMANCE CRITERIA

DESKS

Item D11 Desk, Sr Meter Tech Desk (Left-Side Return)

1. Height-adjustable desk with overhead storage: (1) Box/file low storage, (1) low credenza open shelf, (1) bookshelf and box/file storage combination, (1) tackboard, (1) horizontal wire management trough, (1) vertical cable manager
2. Overall Dimensions: 12'W x 5'-10"D x 6'-1-5/8"H
3. Box/File low storage: 36"W x 23-1/4"D x 20-3/4"H
4. Low credenza open shelf: 36"W x 24"D x 20-3/4"H; cavity at the back of the open shelf is large enough to accommodate item M10 and M11. Removable panel at the back of the shelf to allow for quick access to wiring in cavity.
5. Bookshelf and box/file storage combination: 36"W x 14-1/4"D x 52-7/8"H; box/file is 20-3/4"H; bookshelf attaches on top for a total height of 6'-1-5/8"H. Provide (3) adjustable shelves for bookshelf.
6. Tackboard: 36"W x 3/4"D x 31"H; fabric wrapped; wall mounted between low-credenza two-door storage and overhead storage.
7. Height-adjustable work surface, 1" thick x 70"W x 34"D high-pressure laminate surface with 3mm PVC edge-banding. Grain direction runs left to right.
8. Overhead storage, (1) two-door, 36"W x 15"D x 17-3/16"H. Soft close hinge.

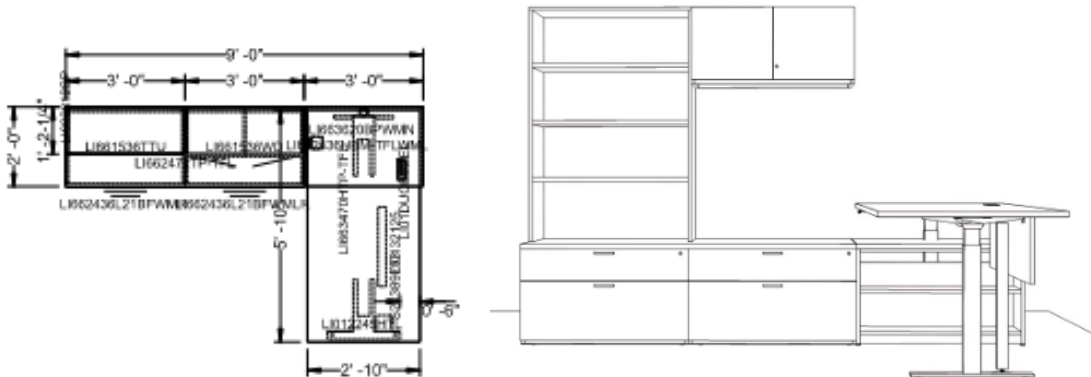

Image shown is similar to Basis of Design product specified and is for reference only. Product requirements are listed above.

**FAIRFAX COUNTY WATER AUTHORITY, WILLARD ROAD MAINTENANCE FACILITY
14925 WILLARD ROAD, CHANTILLY, VA 20151**

TECHNICAL SPECIFICATIONS AND PERFORMANCE CRITERIA

9. Horizontal wire management trough, metal, full length of desk surface with easy access openings
10. Reference item M11 vertical wire manager compatible with item M10 height adjustable legs with easy access openings and install at this desk.
11. Construction: Particle board core with high-pressure laminate surfaces and with PVC edge-banding. Adjustable leveling glides at each storage return.
12. Provide high-pressure laminate modesty panel full length of desk; 3/4" thick x 20-3/4"H; mounted below desk surface leaving 6" between panel and desktop for mounting monitor arm
13. Provide (2) 2" round plastic grommets per desk. Location to be determined in field.
14. Finish: high pressure plastic laminate for all desk and storage surfaces, vertical grain direction on vertical surfaces; grain direction on horizontal surfaces to run in the same direction.
15. All desk storage keyed alike with storage pieces in room
16. Warranty: 12 Years
17. Basis of Design: Desk and Storage, KI Likha Caseloads or Equal.

TECHNICAL SPECIFICATIONS AND PERFORMANCE CRITERIA

STORAGE

Item S01 Laminate Wardrobe Tower

1. Wardrobe Tower: free-standing full vertical height wardrobe with coat hook, front-facing storage cabinet with (1) adjustable shelf, file/file, keyed lock
2. Overall Dimensions: 24"W x 22"D x 48"H
3. File Drawer: 12-1/8"W x 15-9/16"D x 11-1/16"H
4. Cabinet with Open Shelf: 13-1/8"W x 21"D x 48"H cabinet; 3/4" shelf thickness; 20-3/8" shelf depth; shelf range of adjustment 8-1/4" on 1-3/8" centers.
5. Bar pull, positive interlock system allows only one drawer open at a time; one lock controls all drawers and door
6. Construction: Welded high-grade steel metal case with plastic laminate on exposed finished surfaces with vertical grain direction.
7. Drawer Construction: smooth riding ball-bearing slides, full extension
8. Meet or exceed ANSI/BIFMA X5.9-2004 standards
9. Warranty: Limited Lifetime Warranty
10. Basis of Design: KI U-Series Wardrobe Tower or Equal.

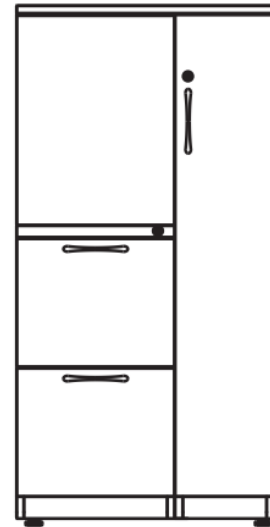

*Image shown is similar to Basis of Design product specified and is for reference only.
Product requirements are listed above.*

TECHNICAL SPECIFICATIONS AND PERFORMANCE CRITERIA

STORAGE

Item S02 Fleet Tech, Metal Wardrobe Tower

1. Wardrobe Tower: free-standing full vertical height wardrobe with coat hook, front-facing storage cabinet with (1) adjustable shelf, file/file, keyed lock
2. Overall Dimensions: 24"W x 22"D x 48"H
3. File Drawer: 12-1/8"W x 15-9/16"D x 11-1/16"H
4. Cabinet with Open Shelf: 13-1/8"W x 21"D x 48"H cabinet; 3/4" shelf thickness; 20-3/8" shelf depth; shelf range of adjustment 8-1/4" on 1-3/8" centers.
5. Bar pull, positive interlock system allows only one drawer open at a time; one lock controls all drawers and door
6. Construction: Welded high-grade steel metal case, epoxy powder-coat.
7. Drawer Construction: smooth riding ball-bearing slides, full extension
8. Meet or exceed ANSI/BIFMA X5.9-2004 standards
9. Warranty: Limited Lifetime Warranty
10. Basis of Design: KI U-Series Wardrobe Tower or Equal.

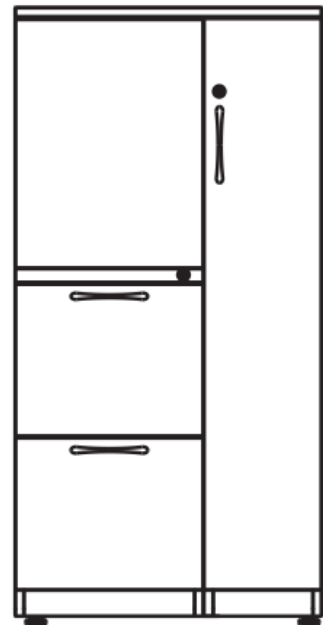

Image shown is similar to Basis of Design product specified and is for reference only. Product requirements are listed above.

TECHNICAL SPECIFICATIONS AND PERFORMANCE CRITERIA

STORAGE

Item S03 Laminate Lateral File

1. Free-standing Lateral File: Three 12”H drawers, with keyed lock
2. Overall Dimensions: 36”W x 24”D x 43-3/4”H
3. Standard inset pull, positive interlock system allows only one drawer open at a time; one lock controls all drawers. Coordinate keying with owner.
4. Construction: Welded high-grade steel metal case with plastic laminate on exposed finished surfaces with vertical grain direction.
5. Drawer Construction: Drawer fronts 3 /4” thick with matched grain; sides, back, and front are wood grain vinyl-wrapped, 1 /2” thick. Handle detail to be full length of the front of drawer. Drawers provide legal or letter filing front-to-back or side-to-side. Drawers to be full extension, progressive action slides with precision steel ball bearings.
6. Adjustable glides at the base; adjustable from inside
7. Maximum weight allowance: 200lbs
8. Meet or exceed ANSI/BIFMA X5.9-2004 standards
9. Warranty: Lifetime Warranty
10. Basis of Design: KI Likha Series Lateral File or Equal.



Image shown is similar to Basis of Design product specified and is for reference only. Product requirements are listed above.

TECHNICAL SPECIFICATIONS AND PERFORMANCE CRITERIA

STORAGE

Item S04 Metal Lateral File

1. Free-standing Metal Lateral File: Three 12”H drawers, with keyed lock
2. Overall Dimensions: 36”W x 18”D x 39 ¼”H
3. Standard inset pull, positive interlock system allows only one drawer open at a time; one lock controls all drawers. Coordinate keying with owner.
4. Construction: Welded high-grade steel metal case and drawer fronts, powder coat metal finish .
5. Shell Construction: shell components reinforced, spot-welded and MIG-welded together
6. Drawer Construction: drawers constructed using 20-gauge steel formed to a thickness of 3 /4”. Handle detail to be full length of the front of drawer. Drawer ends punched to accept side-to-side folder bars and pockets.
7. Adjustable glides at the base; adjustable from inside
8. Meet or exceed ANSI/BIFMA X5.9-2004 standards
9. Warranty: Lifetime Warranty
10. Basis of Design: KI 700 Series Lateral File or Equal.



Image shown is similar to Basis of Design product specified and is for reference only. Product requirements are listed above.

TECHNICAL SPECIFICATIONS AND PERFORMANCE CRITERIA

STORAGE

Item S05 Metal Bookcase

1. Free-standing metal bookcase: Three 12” deep adjustable metal shelves
2. Overall Dimensions: 36”W x 12”D x 54-9/16”H
3. Shelf Construction: shelves constructed using 22-gauge steel formed to 7/8” in thickness on the front and back edges; epoxy powder-coat paint finish.
4. Shell Construction: flush inner liner welded into box frame for reinforcement
5. Metal adjustable shelves, adjust on 3 /4” increments
6. Base with adjustable glides; 1/8” height
7. Meet or exceed ANSI/BIFMA X5.9-2004 standards
8. Warranty: Lifetime Warranty
9. Basis of Design: KI 700 Series Bookcase or Equal.

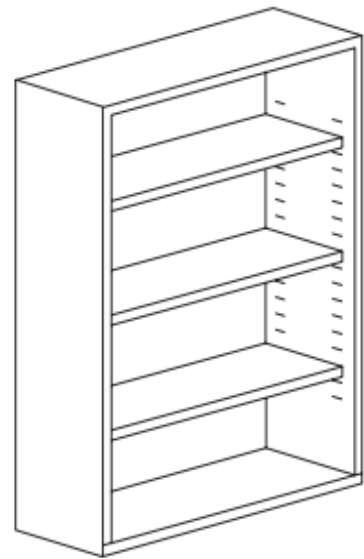

Image shown is similar to Basis of Design product specified and is for reference only. Product requirements are listed above.

TECHNICAL SPECIFICATIONS AND PERFORMANCE CRITERIA

STORAGE

Item S06 Laminate Bookcase

1. Free-standing laminate bookcase: Four 12” deep adjustable shelves
2. Overall Dimensions: 36”W x 14-1/4”D x 82-7/8”H
3. Shelf Construction: shelves constructed using 22-gauge steel formed to 7/8” in thickness on the front and back edges; plastic laminate on exposed surfaces with vertical grain direction, fused to particle-board core.
4. Shell Construction: flush inner liner welded into box frame for reinforcement
5. Laminate adjustable shelves, adjust on 3 /4” increments
6. Base with adjustable glides
7. Meet or exceed ANSI/BIFMA X5.9-2004 standards
8. Warranty: Lifetime Warranty
9. Basis of Design: KI Likha Freestanding Bookcase or Equal.

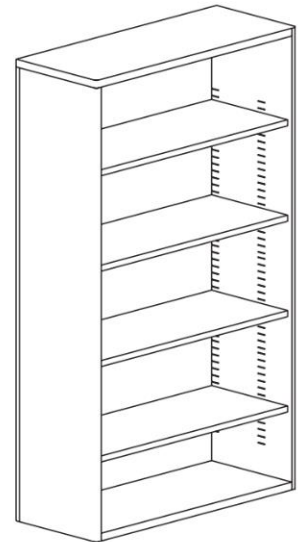

Image shown is similar to Basis of Design product specified and is for reference only. Product requirements are listed above.

TECHNICAL SPECIFICATIONS AND PERFORMANCE CRITERIA

STORAGE

Item S07 Laminate Bookcase

1. Free-standing Laminate bookcase: Three 12” deep adjustable shelves
2. Overall Dimensions: 36”W x 14-1/4”D x 58-7/8”H
3. Shelf Construction: shelves constructed using 22-gauge steel formed to 7/8” in thickness on the front and back edges; plastic laminate on exposed surfaces with vertical grain direction.
4. Shell Construction: flush inner liner welded into box frame for reinforcement
5. Laminate adjustable shelves, adjust on 3 /4” increments
6. Base with adjustable glides
7. Meet or exceed ANSI/BIFMA X5.9-2004 standards
8. Warranty: Lifetime Warranty
9. Basis of Design: KI Likha Freestanding Bookcase or Equal.

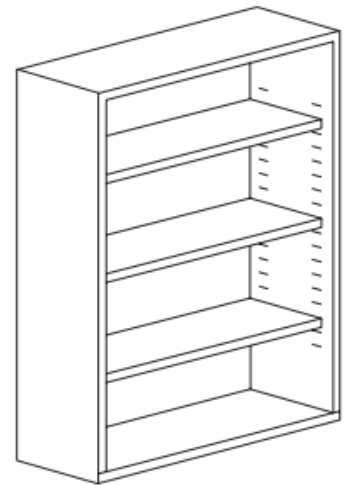

Image shown is similar to Basis of Design product specified and is for reference only. Product requirements are listed above.

TECHNICAL SPECIFICATIONS AND PERFORMANCE CRITERIA

STORAGE

Item S08 Storage 215 Metal Bookcase

1. Free-standing Metal Bookcase: Four 12” deep metal adjustable shelves
2. Overall Dimensions: 36”W x 12”D x 66 -13/16”H
3. Shelf Construction: shelved constructed using 22-gauge steel formed to 7/8” in thickness on the front and back edges; epoxy powder-coat paint finish
4. Shell Construction: flush inner liner welded into box frame for reinforcement
5. Metal adjustable shelves on 3 /4” increments
6. Base with adjustable glides, 1/8” height
7. Meet or exceed ANSI/BIFMA X5.9-2004 standards
8. Warranty: Lifetime Warranty
9. Basis of Design: KI 700 Series Bookcase or Equal.

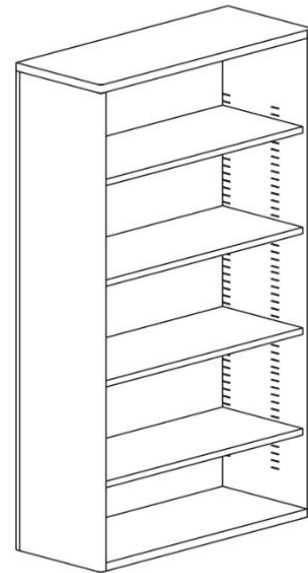

Image shown is similar to Basis of Design product specified and is for reference only. Product requirements are listed above.

TECHNICAL SPECIFICATIONS AND PERFORMANCE CRITERIA

STORAGE

Item S09 Map Room Flat files

1. Quantity (2) 5-drawer high freestanding flat files stacked on top of each other on a 6”H base
2. Overall dimensions: 46” W x 32” D x 39” H
3. Drawers are 2.125”H x 43”W for maximum sheets sized 30”W x 42”L; hold 500 active or 1,000 inactive sheets; heavy duty drawers rails and side-roller assembly with ball bearings; positive closures and courtesy stops for safety keeps drawers closed
4. Metal base: 6”H x 46”W x 32”D, recessed design for toe space
5. Include label holders, chrome drawer pulls, and antislip pads for stacking
6. Rear hood and hinged front depressor protect sheets and prevent curling
7. Sturdy inner frame supports for stacking strength
8. Provide counterweight per manufacturer’s recommendation.
9. Construction: Welded construction with double thick wraparound corners, powder-coated finish is safe for archiving
10. Warranty: 5 Year Limited
11. Basis of Design: Gaylord Archival- Safco Flat Files or Equal



Image shown is similar to Basis of Design product specified and is for reference only. Product requirements are listed above.

TECHNICAL SPECIFICATIONS AND PERFORMANCE CRITERIA

STORAGE

Item S10 Archive Room, Flat Files

1. Quantity (3) 5-drawer high freestanding flat files stacked on top of each other on a 6”H base
2. Overall dimensions: 46” W x 32” D x 55-1/2” H
3. Drawers are 2.125”H x 43”W for maximum sheets sized 30”W x 42”L; hold 500 active or 1,000 inactive sheets; heavy duty drawers rails and side-roller assembly with ball bearings; positive closures and courtesy stops for safety keeps drawers closed
4. Metal base: 6”H x 46”W x 32”D, recessed design for toe space
5. Include label holders, chrome drawer pulls, and antislip pads for stacking
6. Rear hood and hinged front depressor protect sheets and prevent curling
7. Sturdy inner frame supports for stacking strength
8. Provide counterweight per manufacturer’s recommendation.
9. Construction: Welded construction with double thick wraparound corners, powder-coated finish is safe for archiving
10. Warranty: 5 Year Limited
11. Basis of Design: Gaylord Archival- Safco Flat Files or Equal



Image shown is similar to Basis of Design product specified and is for reference only. Product requirements are listed above.

TECHNICAL SPECIFICATIONS AND PERFORMANCE CRITERIA

STORAGE

Item S11 Map Room Vertical File

1. Free-standing Metal Vertical File: Four 11”H drawers, with keyed lock
2. Overall Dimensions: 15”W x 27-5/8”D x 48”H
3. Standard inset pull, positive interlock system allows only one drawer open at a time; one lock controls all drawers. Coordinate keying with owner.
4. Construction: Welded high-grade steel metal case and drawer fronts, powder coat metal finish
5. Shell Construction: four vertical uprights pierced on approximately 11” centers to all suspensions to be clipped in. Base reinforced to allow adjustable levelling glides; base with adjustable glides, adjustable from inside.
6. Drawer Construction: Fronts screw mounted to drawer body. Outer front fabricated from 22-gauge steel with 1-3 /4” wide handle recess and flanges on all four sides. Drawers designed with offsets and slots to allow adjustable follower block; sides are bossed and pre-punched to allow suspensions. Drawer bodies to accommodate suspended file folders and option of hanging folder bars.
7. Meet or exceed ANSI/BIFMA X5.9-2004 standards
8. Warranty: Lifetime Warranty
9. Basis of Design: KI 700 Series Vertical File or Equal.



Image shown is similar to Basis of Design product specified and is for reference only. Product requirements are listed above.

TECHNICAL SPECIFICATIONS AND PERFORMANCE CRITERIA

STORAGE

Item S12 Chrome Wire Shelving

1. Chrome Wire Shelving, Four adjustable shelves, glides
2. Overall Dimensions: 36"W x 18"D x 72"H
3. Open wire shelving for maximum airflow and dirt and dust reduction. 1-1/4" thick shelves adjust in 1" increments
4. Shelf Capacity: 800lbs per shelf
5. Certifications: NSF
6. Basis of Design: Uline Chrome Wire Shelving or Equal.



Image shown is similar to Basis of Design product specified and is for reference only. Product requirements are listed above.

TECHNICAL SPECIFICATIONS AND PERFORMANCE CRITERIA

STORAGE

Item S13 Credenza

1. Freestanding Storage Credenza: enclosed 3-door storage, 1-1/8" thick single laminate top, laminate door fronts, locking; 2-1/4"H base with 1" leveling glides; interior includes (1) adjustable shelf; curved pull handles
2. Overall dimensions: One credenza 54"W x 22"D x 29"H
3. Construction: Particle board with 1/32" plastic laminate finish, solid wood front edge and plastic laminate finish on three sides with vertical grain direction; plastic laminate exposed surfaces finish to match item T-02. Steel door hinges.
4. Adjustable shelf, adjust in 1" increments
5. Warranty: 12-year Parts & Labor Manufacturer's Warranty
6. Items T-02 and T-03 must be from same manufacturer to match laminate finish
7. Basis of Design: KI Serenade Credenza or Equal.

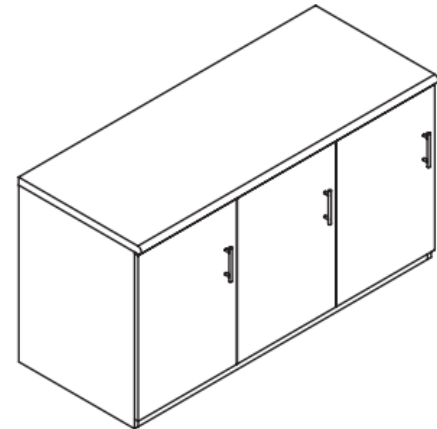

Image shown is similar to Basis of Design product specified and is for reference only. Product requirements are listed above.

TECHNICAL SPECIFICATIONS AND PERFORMANCE CRITERIA

STORAGE

Item S14 Archive Room, High Density Mobile Shelving

1. High Density Mobile Shelving: storage housings mounted on wheeled carriage assemblies riding on multiple steel rails. Low profile mechanical assist carriages accessed by means of one roving aisle.
2. Overall Dimensions: 21'-5" W x 22' 2-1/4" L x 7'- 1-1/4" H
3. Quantity (5) Double-Faced Shelving Carriages, each 30" W x 22' 2-1/4" L x 7' 1-1/4" H comprised of (5) 42" W Double-Faced Shelving Units and (1) 48"W Double-Faced Shelving Unit with a steel end panel.
4. Quantity (2) Single-Faced Shelving Carriages, each 30" W x 21' 8-1/4" L x 7' 1-1/4" H comprised of (5) 42" W Single-Faced Shelving Units and (1) 48"W Double-Faced Shelving Unit with steel end panel. All Single-Faced Shelving Units have a full height steel back panel to comply with Fire Department code requirements. Space each Single-Faced Shelving Carriage 60" apart with (2) Double-Faced Carriages between them.
5. 42"W Single-Faced Shelving Units are 4-post case-style comprised of (2) 15" D shelving cases placed back-to-back with full-height steel back panels separating to comply with Fire Department code requirements. Overall unit dimensions: 30" W x 42" L.
6. 48"W Single-Faced Shelving Units are 4-post case-style comprised of (2) 15" D shelving cases placed back-to-back with full-height steel back panels separating to comply with Fire Department code requirements. Overall unit dimensions: 30" W x 48" L.
7. 42"W Double-Faced Shelving Units are 4-post case-style construction comprised of 15" D open shelves with 4" H back at each shelf; 30" W x 42" L
8. 48"W Double-Faced Shelving Units are 4-post case-style construction comprised of 15" D open shelves with 4" H back at each shelf; 30" W x 48" L
9. Quantity (7) shelves per unit, each shelf 12" apart, 11.25" clearance between shelves. Shelves attach to posts with adjustable brackets in 1-1/2" increments.
10. Raised deck with steel ramp and barrier-free concrete rail. Ramp to raised deck is ADA compliant. Finish flooring to be installed on top of raised deck by contractor after rail and deck installation.

TECHNICAL SPECIFICATIONS AND PERFORMANCE CRITERIA

11. Drive Assembly and Safety: Triple arm operating control with ergonomic knobs located on the drive ends at ADA reach height, one operation knob per carriage. Front drive control consisting of chain, sprocket, and upper drive bearing assembly enclosed in a steel housing integral to the carriage structure. Carriage end panel drive assemblies that attach to the face panel and are not supported by a dedicated structure are unacceptable and will be rejected. Drive system must provide a movement of up to 4,000 lbs. of load with 1lb. of user effort at the carriage control handle. User activated safety locking mechanism to be provided at every carriage control handle. All bearings permanently lubricated and shielded.
12. Construction: Carriages formed of welded structural steel frame with machined steel wheels aligning to corresponding steel rails. All metal supports shelves and end panels made of 40% recycled steel; non-VOC emitted scratch-resistant textured powder-coat painted finish all exposed surfaces. A minimum of 25 standard manufacturer's colors shall be offered at no additional charge. Any special color match shall be made available per the standard manufacturer's published policy.
13. Storage units must be capable of withstanding the effects of earthquake motion as required by applicable building codes.
14. Project Conditions:
 - a. Verify measurements in field prior to fabrication. Comply with sprinkler code requirements by ensuring rail with required grout for leveling, raised platform, carriage structure, and storage housing heights are accounted for in overall system height. Overall System height not to exceed 7'-10"
15. Quality Assurance:
 - a. Engage an experienced manufacturer who has been manufacturing this type of shelving continuously at the same location for a period of time not less than 50 years and whose internal processes meet or exceed ISO 9001 requirements.
 - b. Engage an experienced installer who is authorized by the manufacturer to install high-density shelving and has done so for a minimum of one year.
 - c. A list shall be submitted of all specification deviations with a complete description and validation.

TECHNICAL SPECIFICATIONS AND PERFORMANCE CRITERIA

16. Scheduling, Delivery, Storage, and Handling:

- a. Schedule and attend in-person pre-installation conference on project site to review methods, procedures, and logistic details for installation of high-density shelving with the General Contractor, architect, and owner.
- b. Coordinate fabrication and delivery with the General Contractor, architect, and owner to ensure no delay in progress of work.
- c. Provide a schedule for sequence of installation to the General Contractor, architect, and owner for approval prior to schedule of delivery.
- d. Installation schedule must coordinate with the General Contractor's schedule of construction for the Archives Room. Ramp and raised deck to be installed after floor is prepped, walls are painted complete, wall base is installed, and punch list items by architect have been completed. Carriages to be installed after the General Contractor has installed the flooring on the raised deck and punch list items by architect related to the flooring have been completed.
- e. Notify the General Contractor, architect, and owner of daily progress during installation.
- f. Comply with all instructions and recommendations made by manufacturer for delivery, storage, and handling requirements.

17. Warranty: Limited Lifetime Warranty.

- a. Provide a written warranty, executed by contractor, installer, and manufacturer, agreeing to repair or replace equipment which fails in materials or workmanship within the established warranty period. This warranty shall be in addition to, and not a limitation of, other rights the owner may have under general conditions provisions of the contract documents
- b. In addition, shall warrant the high-density mobile storage system against defects in material and workmanship for a minimum of 10 years from date of final acceptance by owner.

18. Basis of Design: Aurora High Density Mobile System, Low Profile Mechanical Assist or Equal

TECHNICAL SPECIFICATIONS AND PERFORMANCE CRITERIA

TABLES

Item T01 Meter Shop Café Height Table with Casters

1. Rectangular Café Height Table: Fixed height, locking casters
2. Overall Dimensions: 60"W x 36"D x 36"H
3. High pressure laminate worksurface with particleboard core, phenolic backer on bottom.
Welded steel base frame with powder coat finish surface
4. Meet or exceed ANSI/BIFMA X5.5-2021
5. Warranty: Limited Lifetime Warranty
6. Basis of Design: KI Stout Table or Equal.



*Image shown is similar to Basis of Design
product specified and is for reference only.
Product requirements are listed above.*

TECHNICAL SPECIFICATIONS AND PERFORMANCE CRITERIA

TABLES

Item T02 Conference Room Table

1. Conference Table: 120” L x 48” W x 28.5” H, with Column Base; plastic laminate surfaces; concealed power and data grommet mounted bucket, power module, leveling glides
2. Table top: boat-shape plastic laminate tabletop with solid wood t-edge. Quantity (1) center cut-out in table for concealed power and data grommet mounted bucket
3. Column Bases: quantity (2) each 12”W with adjustable glides, 1” in diameter for a level set-up within 2” of adjustable height. Access door in base for access to wire management; coordinates with modesty panel mounted under table surface for complete concealment of wires.
4. Modesty Panel: 12”H x 10”W. Power and data cables are routed and hidden within the modesty panel. Constructed on particle board with plastic laminate surface finish.
5. Concealed power and data grommet mounted bucket: lid conceals receptacles; coordinates with undersurface trough for wire management; (4) pass-through openings for data cords to be routed into bucket
6. Power Module: Mounts inside grommet mounted bucket; module is powered with standard power cord with plug end; (4) AC simplex receptacles and (4) USB receptacles; 180” long cord length
7. Construction: 1-1/8” thick, 45lb density particle board core with a plastic laminate finished top surface with a phenolic backing; column base and modesty panel manages and conceals wires, and allows access to power.
8. Warranty: Lifetime Warranty
9. Basis of Design: KI Serenade Conference Table or Equal.



Image shown is similar to Basis of Design product specified and is for reference only. Product requirements are listed above.

TECHNICAL SPECIFICATIONS AND PERFORMANCE CRITERIA

TABLES

Item T03 Conference Room 208 Table

1. Conference Table: 168" L x 54" W x 28.5" H, with Column Base; plastic laminate surfaces; concealed power and data grommet mounted bucket, power module, leveling glides
2. Table top: boat-shape plastic laminate tabletop with solid wood t-edge. Quantity (2) center cut-out in table for concealed power and data grommet mounted bucket
3. Column Bases: quantity (2) each 12"W with adjustable glides, 1" in diameter for a level set-up within 2" of adjustable height. Access door in base for access to wire management; coordinates with modesty panel mounted under table surface for complete concealment of wires.
4. Modesty Panel: 12"H x 10"W. Power and data cables are routed and hidden within the modesty panel. Constructed on particle board with plastic laminate surface finish.
5. Concealed power and data grommet mounted bucket: lid conceals receptacles; coordinates with undersurface trough for wire management; (4) pass-through openings for data cords to be routed into bucket
6. Power Module: Mounts inside grommet mounted bucket; module is powered with standard power cord with plug end; (4) AC simplex receptacles and (4) USB receptacles; 180" long cord length
7. Construction: 1-1/8" thick, 45lb density particle board core with a plastic laminate finished top surface with a phenolic backing; column base and modesty panel manages and conceals wires, and allows access to power.
8. Warranty: Lifetime
9. Basis of Design: KI Serenade Conference Table or Equal.



Image shown is similar to Basis of Design product specified and is for reference only. Product requirements are listed above.

TECHNICAL SPECIFICATIONS AND PERFORMANCE CRITERIA

TABLES

Item T04 Round Side Table

1. Round Pedestal Table: 36” DIA x 29”H
2. Construction: Metal steel pedestal supports high pressure plastic laminate table top with matching PVC edge banding
3. Adjustable height glides with 1 /2” leveling range
4. Finishes to match items D01, D02, and D07
5. Basis of Design: KI Athens Table or Equal.



*Image shown is similar to Basis of Design
product specified and is for reference only.
Product requirements are listed above.*

TECHNICAL SPECIFICATIONS AND PERFORMANCE CRITERIA

TABLES

Item T05 Map Room Square Worktable

1. Worktable: 54"D x 60"L x 36"H; counter-height Laminate Worksurface with steel open cubby storage below, locking casters
2. Laminate Worksurface: 1-1/4" thick particle board core with HPL surface with matching 2mm polypropylene bonded edge-banding. Worksurface overhangs Steel Base Shell a minimum of 11" on all four sides. Worksurface attaches to base with pre-drilled dowels and thumb screws which can be removed from base without tools to fit through doorways
3. Steel Base Shell: quantity (2) Single-Faced Units placed back-to-back and joined by a 12-gauge drop-in ganging plate. Units can separate when the worksurface is removed to allow fitting through doorways.
4. Single Faced Units: quantity (4) open cubbies storage, each shelf is 13 5/8" W x 17 7/8" D x 13 5/8" H. Two fixed 3/4" thick shelves made of 22-gauge steel mounted centered.
5. Casters: quantity (4) 3" Industrial-grade castors per Single Faced Unit. Plate mounted with double ball bearing swivel head. Two front casters lock, two back casters no lock.
6. Construction: 20-gauge cold rolled steel double wall base with spot-welded upright members and top reinforcements for vertical strength. Quantity (2) 18-gauge MIG welded-in-place structurally formed reinforcements along the bottom front and back of the Steel Base Shell. Hybrid epoxy powder-coat metal finish all exposed surfaces with high pressure laminate worksurface.
7. Provide manufacturer's full-range of metal and laminate finish options at no extra charge to owner.
8. Warranty: 15-year Limited
9. Basis of Design: KI Ruckus Worktable or Equal.



Image shown is similar to Basis of Design product specified and is for reference only. Product requirements are listed above.

TECHNICAL SPECIFICATIONS AND PERFORMANCE CRITERIA

TABLES

Item T06 Break/Training Room Table

1. Rectangular Training Table: Flip top, nesting, T-leg, flexible modesty panel, powered with horizontal wire management trough, vertical cord cover, single circuit power entry, castors suitable for used on hard floors
2. Overall dimensions: 60" W x 24" D x 29" H
3. High pressure laminate top with thermoplastic edge banding, square edge; flipping mechanism mounted under top is accessible from front edge
4. Power cut-out in table for grommet-mount electrical distributor that is flush with surface; 12-3/4" L x 5" W x 4" D; one touch pop-up mechanism for access to power; power cord with plug end; provide 3 simplex receptacles, 2 data openings, and 2 USB charging ports; UL Listed
5. Casters suitable for use on hard floors, all four castors with locking abilities
6. Flexible modesty panel extends entire length of top and folds to allow tables to nest; aluminum top rail and attachment brackets
7. Horizontal wire management trough, 5-3/4" W x 4-1/4"D, extends entire length of top; made of metal and attaches to underside of top with easy access openings; mounting location coordinates with modesty panel; finish coordinates with finish of table leg
8. Vertical wire management cord cover, attaches to T-leg of table, 20" L, easy access openings for cable management; provide a cord cover on both legs of table; finish coordinates with finish of table leg



Image shown is similar to Basis of Design product specified and is for reference only. Product requirements are listed above.

**FAIRFAX COUNTY WATER AUTHORITY, WILLARD ROAD MAINTENANCE FACILITY
14925 WILLARD ROAD, CHANTILLY, VA 20151**

TECHNICAL SPECIFICATIONS AND PERFORMANCE CRITERIA

9. Single circuit power entry, 10' long cord, 15-amp power entry provides power for single circuit electrical distributors; allows up to 8 single circuit distributors to be daisy chain connected in any order; includes standard attachment hardware
10. Construction: Metal T-leg with powder-coat finish, high pressure plastic laminate tabletop surface with thermoplastic edge banding; all metal components are the same finish and color
11. Warranty: Lifetime Warranty
12. Basis of Design: KI Pirouette Table or Equal.

TECHNICAL SPECIFICATIONS AND PERFORMANCE CRITERIA

TABLES

Item T07 Open Area Café Height Table

1. Café Height Table: Fixed height, dual footrest
2. Overall Dimensions: 60"W x 36"D x 36"H
3. High pressure laminate worksurface with particleboard core, phenolic backer on bottom.
Welded steel base frame with powder coat finish surface
4. Nylon glides overmolded on steel insert, provided 1" adjustment range
5. Meet or exceed ANSI/BIFMA X5.5-2021
6. Warranty: Limited Lifetime Warranty
7. Basis of Design: KI Stout Table or Equal.



*Image shown is similar to Basis of Design
product specified and is for reference only.
Product requirements are listed above.*

TECHNICAL SPECIFICATIONS AND PERFORMANCE CRITERIA

TABLES

Item T08 Patio Outdoor Picnic Table

1. Steel Frame Table: 86” DIA x 33”H, (4) attached contoured seats with backs
2. Construction: 2” diameter steel tubing supports table top and attached seats, perforated heavy gauge steel table top and seats with powder coat painted finish
3. Umbrella hole in table top and holder in base for umbrella by others to be compatible with M08
4. Freestanding with glides
5. Product weight: 211lbs
6. Basis of Design: Landscape Forms Carousel Picnic Table or Equal.



Image shown is similar to Basis of Design product specified and is for reference only. Product requirements are listed above.

TECHNICAL SPECIFICATIONS AND PERFORMANCE CRITERIA

TABLES

Item T09 Patio ADA Picnic Table

1. Steel Frame Table: 86” DIA x 33”H, (3) attached contoured seats with backs
2. Construction: 2” diameter steel tubing supports tabletop and attached seats, perforated heavy gauge steel table top and seats with powder coat painted finish
3. Umbrella hole in table top and holder in base for umbrella by others to be compatible with M08
4. Surface mounted with bolts into floor
5. ADA Compliant, opening on side for wheelchair accessibility
6. Product weight: 172lbs
7. Basis of Design: Landscape Forms Carousel Picnic Table or Equal.



*Image shown is similar to Basis of Design product specified and is for reference only.
Product requirements are listed above.*

TECHNICAL SPECIFICATIONS AND PERFORMANCE CRITERIA

MISCELLANEOUS ITEMS

Item M01 LED Task Light with Charging Base/USB Charging Port

1. LED Task Light: Full-range dimming capabilities, flexible arm with 360 degree rotation, 360 degree shade rotation, 180 degree tilt; ADA Compliant Optical Switch, USB charging port and wireless charging integrated in the base
2. Overall Dimensions: 5"W x 6"D x 16.5"; when folded flat, profile is .75"H; cord length is 6' long
3. Voltage: 120-240V 50-60Hz
4. Power Consumption: 6W MAX
5. Color Temperature: 3000K
6. Luminosity: 325 Lumens
7. Color Rendition Index: 90 CRI
8. 50K hour lifespan
9. Certifications: ETL, CE, PSE, RoHS
10. Warranty: 1 Year
11. Basis of Design: Pablo, PIXO PLUS Lamp or Equal.

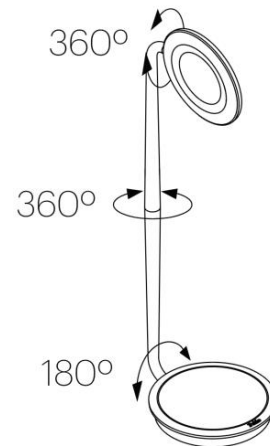

Image shown is similar to Basis of Design product specified and is for reference only. Product requirements are listed above.

TECHNICAL SPECIFICATIONS AND PERFORMANCE CRITERIA

MISCELLANEOUS ITEMS

Item M02 Desktop Fan

1. Desktop Fan: adjustable head, two speeds, three blades
2. Overall Dimensions: 5"W x 4.9"D x 6.2"H; cord length is 6' long.
3. Blade Diameter: 3.2"
4. Amps: 0.12
5. Voltage: 120V 60Hz
6. Power Consumption: 14W
7. Max CFM: 25
8. Warranty: 3 Years
9. Basis of Design: Vornado Flippi V6 Personal Air Circulator



*Image shown is similar to Basis of Design product specified and is for reference only.
Product requirements are listed above.*

TECHNICAL SPECIFICATIONS AND PERFORMANCE CRITERIA

MISCELLANEOUS ITEMS

Item M03 Trash Receptacle

1. Trash Receptacle: 23 gallon capacity; 11”W x 20”D x 30”H
2. Thin profile to fit in tight spaces
3. Built-in finger grips on top rim and handles on bottom for easy lifting and dumping
4. Construction: Heavy duty plastic, resists dents and corrosion
5. No lid or closure
6. Warranty: 1-Year Limited
7. Basis of Design: Global Industrial Slim Trash Can



Image shown is similar to Basis of Design product specified and is for reference only. Product requirements are listed above.

TECHNICAL SPECIFICATIONS AND PERFORMANCE CRITERIA

MISCELLANEOUS ITEMS

Item M04 Recycling Receptacle

1. Recycling Receptacle: 23-gallon capacity; 11”W x 20”D x 30”H
2. Thin profile to fit in tight spaces
3. Built-in finger grips on top rim and handles on bottom for easy lifting and dumping
4. Universal recycling logo for clear identification
5. Construction: Heavy duty plastic, resists dents and corrosion
6. No lid or closure
7. Warranty: 1-Year Limited
8. Basis of Design: Global Industrial Slim Recycling Can



Image shown is similar to Basis of Design product specified and is for reference only. Product requirements are listed above.

TECHNICAL SPECIFICATIONS AND PERFORMANCE CRITERIA

MISCELLANEOUS ITEMS

Item M05 Deskside Trash Receptacle

1. Trash Receptacle: 28 1/8 quart capacity; 14-1/2" W x 10-1/2"D x 15"H
2. Rounded corners and curved lip for extra strength, raised-edge bottom for stability
3. Construction: Heavy duty plastic, resists dents and corrosion
4. No lid or closure
5. Warranty: 1-Year Limited
6. Basis of Design: Global Industrial or Grainger or Equal.



Image shown is similar to Basis of Design product specified and is for reference only. Product requirements are listed above.

TECHNICAL SPECIFICATIONS AND PERFORMANCE CRITERIA

MISCELLANEOUS ITEMS

Item M06 Deskside Recycling Receptacle

1. Recycling Receptacle: 28-1/8 quart capacity; 14-1/2"W x 10-1/2"D x 15"H
2. Universal recycling logo for clear identification
3. Rounded corners and curved lip for extra strength, raised-edge bottom for stability
4. Construction: Heavy duty plastic, resists dents and corrosion
5. No lid or closure
6. Warranty: 1-Year Limited
7. Basis of Design: Global Industrial or Grainger or Equal.



Image shown is similar to Basis of Design product specified and is for reference only. Product requirements are listed above.

TECHNICAL SPECIFICATIONS AND PERFORMANCE CRITERIA

MISCELLANEOUS ITEMS

Item M07 Break Room/ Training Room Trash and Recycling Receptacle

1. Two-compartment Trash and Recycling Receptacle: 10 gallon capacity per compartment;
38"W x 30"H x 11"D
2. Thin profile to fit in tight spaces
3. Includes (2) polyethylene liner bag retainers and recycling and waste decals
4. Top opening to each compartment is oval shape for multi-stream waste; no lid closure
5. Hinged front cabinet door for access to bag retainers for emptying
6. Construction: Frame steel with polyurethane finish; side material powder coat steel; top 1"
MDF (formaldehyde free) with graphite powder coat finish
7. Basis of Design: Peter Pepper Remix Multi-Stream Receptacle or Equal.



*Image shown is similar to Basis of Design
product specified and is for reference only.
Product requirements are listed above.*

TECHNICAL SPECIFICATIONS AND PERFORMANCE CRITERIA

MISCELLANEOUS ITEMS

Item M08 Patio Outdoor Picnic Umbrella

1. Commercial Outdoor Umbrella: 7.5' canopy span with post for mounting in tables
2. Overall dimensions: 92" H x 90" W x 90" D
3. Commercial-grade outdoor fabric, 8-panel octagon canopy with custom multi-color brand logo printed on two panels, pantone matching colors; wind vents and fiberglass ribs
4. Aluminum Pole: 1.5" diameter; pop-up opening system
5. Solution-dyed acrylic outdoor fabric
6. Warranty: 1-year limited
7. Basis of Design: Umbrella Source 7.5' Market Commercial Umbrella with custom logo or Equal



*Image shown is similar to Basis of Design product specified and is for reference only.
Product requirements are listed above.*

TECHNICAL SPECIFICATIONS AND PERFORMANCE CRITERIA

MISCELLANEOUS ITEMS

Item M09 Map Room Countertop

1. Plastic Laminate Countertop, mounted on top of flat files
2. Overall Dimensions: 7'-8"W x 3'-0"D x 1.75"H
3. Construction: Plywood or MDF substrate with plastic laminate surface, squared edge with matching 3mm PVC edge banding; plastic laminate finish all exposed surfaces
4. Provide manufacturers full-range of plastic laminate color options for owner selection
5. Certification: AWI or WI Certified; Architectural Woodwork Standards Grade, Premium
6. Installation: Mount on top of S07 Flat Files, secure to wall and/or files with fasteners so that fasteners are hidden from view, caulk edge where countertop meets the wall; adhesives containing urea formaldehyde strictly prohibited; countertop overhangs edge of files 1" without obstructing use of file drawers
7. Finish to match item T-05 laminate top.
8. Basis of Design: KI with Wilsonart Plastic Laminate finish

TECHNICAL SPECIFICATIONS AND PERFORMANCE CRITERIA

MISCELLANEOUS ITEMS

Item M10 Adjustable Height Desk Mechanism Base

1. Adjustable Height Desk Base: Lift mechanism with T-style legs
2. Base Width: 42” – 62”
3. Height Range: 27.6” – 46.9”
4. Power: 110V – 240V
5. Accommodates surfaces 24”-30” deep
6. Expandable frame to accommodate worksurfaces 48”-72” wide
7. Noise level below 50 decibel
8. Programmable digital hand switch with built-in USB-A and USB-C ports adjusts by touch. Stores preferred height options while charging the device.
9. Height range supports standard ergonomic seating positions up to the BIFMA recommended maximum standing height of 48”H
10. Warranty: 5 Years, 24/7
11. Basis of Design: Humanscale EFloat Go 2.0 or Equal.



Image shown is similar to Basis of Design product specified and is for reference only. Product requirements are listed above.

TECHNICAL SPECIFICATIONS AND PERFORMANCE CRITERIA

MISCELLANEOUS ITEMS

Item M11 Desk Cable Management

1. Desk Cable Management: Powered cable management for height-adjustable desks
2. Cord length is minimum 8' long
3. 3-Stage telescoping leg
4. Access to power through 6-outlet power strip
5. Data model for easy routing to ethernet connections
6. Warranty: 5 Years
7. Basis of Design: Humanscale NeatUp 2.0, Height-Adjustable Cable Management, Power Only or Equal.

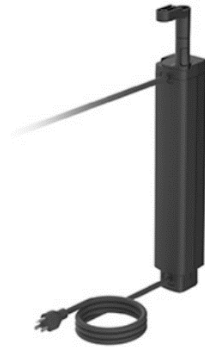

Image shown is similar to Basis of Design product specified and is for reference only. Product requirements are listed above.

TECHNICAL SPECIFICATIONS AND PERFORMANCE CRITERIA

MISCELLANEOUS ITEMS

Item M12 Monitor Arm

1. Monitor Arm: worksurface attachable monitor arm
2. Height Adjustable up to 12”
3. Weight capacity: Heavy single or dual monitors 6-28 lbs
4. Rubberized cable management to run cords through modular systems
5. Weight-compensating spring technology for smooth and uniform height adjustment
6. Customizable arm rotation that prevents overhang
7. Hold up to two monitors.
8. Warranty: 15 Years, 24/7
9. Basis of Design: Humanscale Adjustable Dual Monitor Arm M8.1



*Image shown is similar to Basis of Design product specified and is for reference only.
Product requirements are listed above.*

TECHNICAL SPECIFICATIONS AND PERFORMANCE CRITERIA

MISCELLANEOUS ITEMS

Item M13 Glass White Board

1. Glass White Board: white color writing surface, magnetic
2. Overall Dimensions: 36"W x 48"H x 1/4" thick glass
3. Install flush mounted to wall with metal z-clips
4. Warranty: 12 Years
5. Basis of Design: Herman Miller Glass White Board

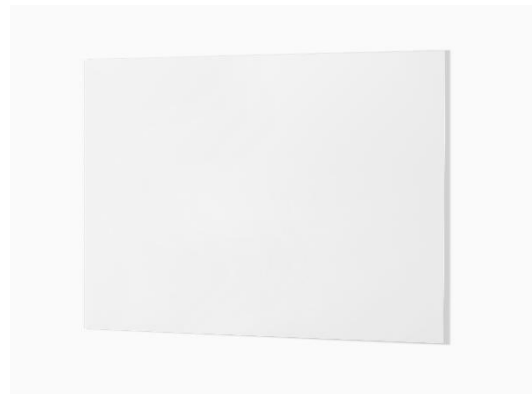

*Image shown is similar to Basis of Design
product specified and is for reference only.
Product requirements are listed above.*

NOTICE:
THIS IS A CONFIDENTIAL DISCLOSURE OWNED BY THE AURORA STORAGE PRODUCTS, INC. SUBJECT TO THE CONFIDENTIALITY AND NON-DISCLOSURE AGREEMENT. THIS DOCUMENT IS INTENDED FOR RECORD AND REFERENCE PURPOSES. SHALL NOT BE USED OR COPIED TO BE USED IN ANY WAY PREJUDICIAL TO THE INTEREST OF THIS COMPANY. SHALL NOT BE REPRODUCED OR COPIED IN WHOLE OR IN PART, AND SHALL BE RETURNED ON REQUEST.

Fairfax Water Archives Rev2

MAFD

DRAWN BY: NRJ
DATE: 04/18/24

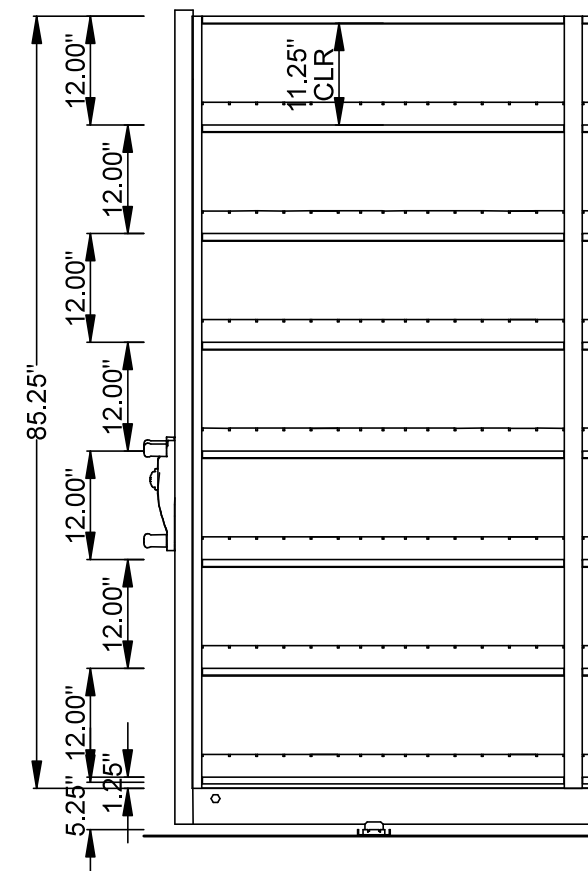
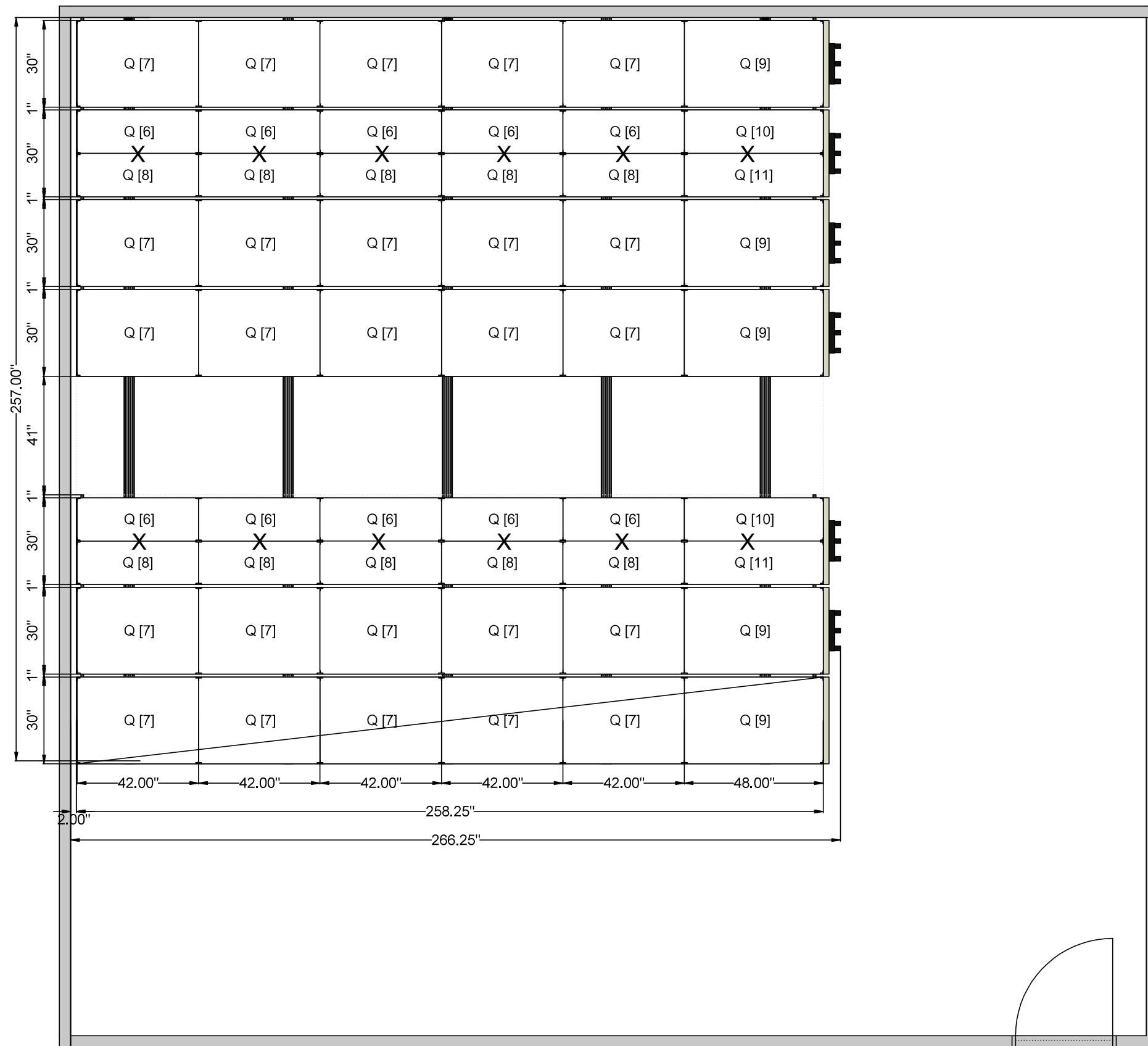

- Mobile System Specs Include:
- Low Profile Mechanical Assist
 - Barrier Free Concrete Rail - Rail Must be Grouted
 - Ergonomic 3 Spoke Handle/High-Visibility
 - Anti-Movement Indicator
 - Steel End Panels

- Aurora 4-Post Shelving
- Shelves Adjustable in 1-1/2" Increments
 - 15"/30" Deep Non-Slotted Shelves
 - 7 Openings Per Section
 - Center Stops Included
 - Back Panels (X) Where Noted On Drawing

- Finish:
- Eco-Friendly Gloss-Tek
 - 28 Standard Colors Available
 - Plus 3 Metallic Finishes Available at Upcharge

APPROVED SIGNATURE _____ DATE _____

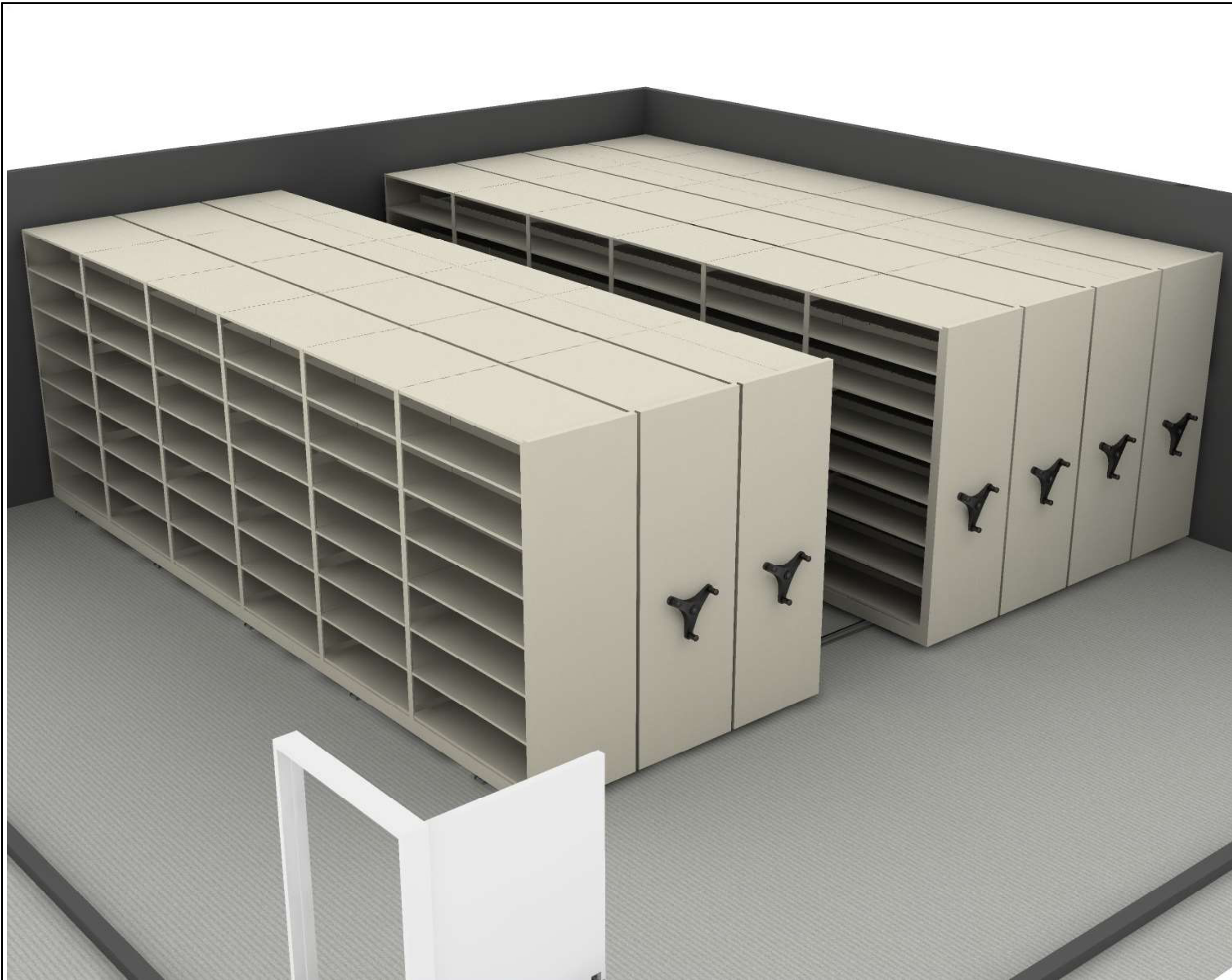

NOTICE:
THIS IS A CONFIDENTIAL DISCLOSURE LOANED BY THE AURORA STORAGE PRODUCTS INC. SUBJECT TO THE CONDITIONS THAT IT AND THE INFORMATION EMBODIED THEREIN SHALL BE USED ONLY FOR RECORD AND REFERENCE PURPOSES. SHALL NOT BE USED OR CAUSED TO BE USED IN ANY WAY PREJUDICIAL TO THE INTEREST OF THIS COMPANY. SHALL NOT BE REPRODUCED OR COPIED IN WHOLE OR IN PART, AND SHALL BE RETURNED ON REQUEST.

Fairfax Water Archives Rev2

MAFD

DRAWN BY: NRJ
DATE: 04/18/24



APPROVED SIGNATURE _____ DATE _____